

L

**LEMKE  
CATTLE**

*Friday* ANNUAL BULL & FEMALE SALE

**FEBRUARY 9, 2024**

AT THE RANCH NEAR LAWRENCE, NE

*1:00 pm*

# Welcome to Lemke Cattle



Thank you for your interest in our 18th Annual Lemke Cattle Bull and Heifer Sale! This year has been very challenging, but also very rewarding. First, we were blessed with a great January and February calving season with outstanding new genetics being born. Then in May, Tanner completed his Animal Science degree from UNL, which fulfilled one of our dreams of having him come back home to partner in our operation! Leslie and I are so proud and excited for the future!

Now the challenges. It was a devastating summer drought in our area. Spring rains never came with the only meaningful rain coming in June, then it shut us off for the rest of the growing season. Several more challenges out of our control came in December and January. Bad weather, Blizzards, and a health issue. I got the call from the doctor's office that no one wants to get. An MRI revealed a cyst in my brain preventing normal pressure and flow of cerebral fluid. Neurosurgeons performed an Endoscopic Third Ventriculostomy (ETV) on January 11th at UNMC. This all happened very fast and I'm home now recovering and wishing I could do more to help Tanner and my brothers with calving. Leslie and I are very grateful for the many well wishes and prayers, they all helped! But mostly we are grateful to the Lord our God for answering our prayers and giving us a chance to ranch and raise seedstock with our son Tanner and to continue watching our family grow.

This sale will include our first Age Advantaged 18 month old bulls as well as the powerful yearlings our customers are used to. Half of the offering are from our ET program and everything is fully guaranteed! There are many breeder type bulls throughout the offering!

Please join us Friday, February 9th at the ranch south of Lawrence, NE and enjoy good cattle, good food, and good people!

*Sincerely, The Lemke family*

## RANDY, LESLIE, SAMMY & MATT, TAYLOR, AND TANNER LEMKE

Randy: 402-469-2284 / Tanner: 402-984-4596

Email: rlemke@gtmc.net

### DIRECTIONS TO THE SALE SITE

1757 Road 2500 / Lawrence, NE 68957

From Lawrence, Nebraska

3 Miles South on Road 2600

1 Mile West on Road T

1/4 Mile South on Road 2500

**LEMKECATTLE.COM**

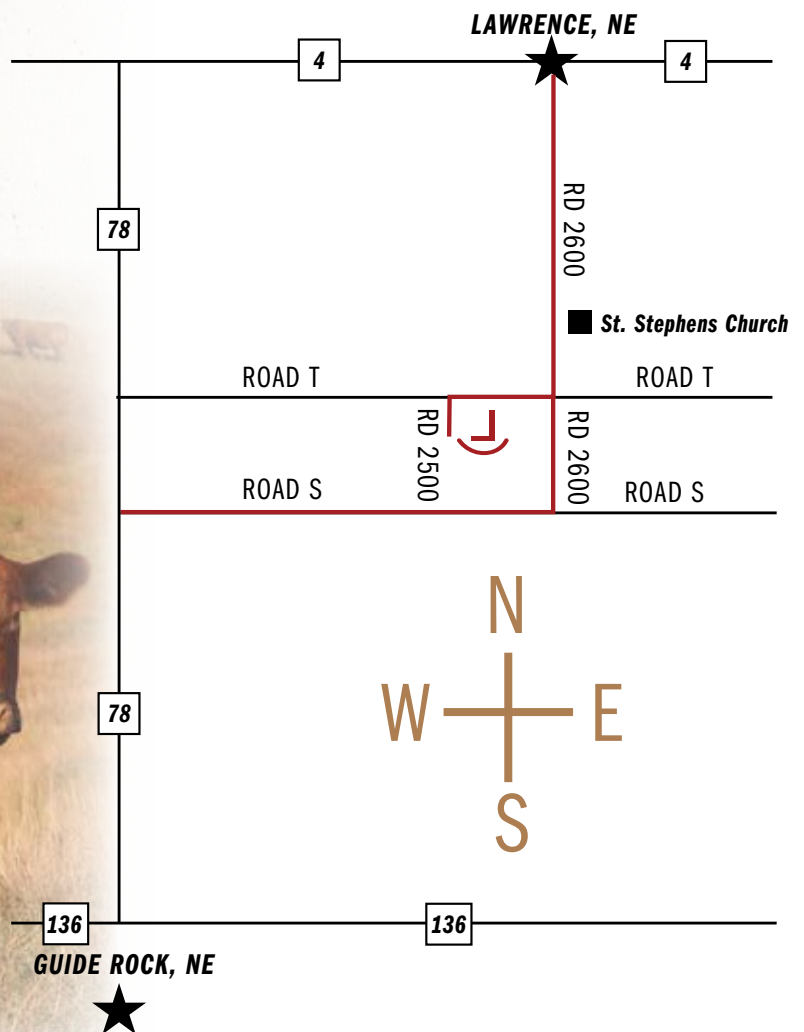

LEMKE CATTLE ANNUAL BULL & FEMALE SALE  FEBRUARY 9, 2024 | LAWRENCE, NEBRASKA



18th Annual Bull Sale

FEBRUARY 9, 2024

1:00 PM – LEMKE SALE FACILITY – LAWRENCE, NE

**SALE DAY CONTACTS**

Home/Sale Barn --- 402-756-7090  
Randy Lemke --- 402-469-2284  
Tanner Lemke --- 402-984-4596  
Leslie Lemke --- 402-469-5589

**AUCTIONEER**

Matt Lowery --- 308-750-6119

**REPRESENTATIVES**

Livestock Digital, Chris Beutler 402-380-8244  
Tri State Livestock News, Cody Nye 308-760-8588  
American Cattlemen, Randy Rasby 308-539-6195

**ACCOMODATIONS**

Green Acres Motel, Red Cloud, NE 402-746-2201  
Comfort Inn, Hastings, NE --- 402-463-5252

**LUNCH** A beef meal will be provided sale day starting at 12:00 PM.

**ONLINE BIDDING & VIDEOS**

For general questions, please contact the office at 402-316-5460.



**ABSENTEE BIDDING**

Call Randy a few days prior to the auction. We can take bids over the phone during the auction, have designated bidders for you, or bid live on DV Auction, whichever you feel comfortable with. All absentee bids will be handled with integrity and professionalism.

**GUARANTEE**

All bulls are covered 100% to be sound & fertile. Buyers of all bulls selling for \$4,000 or more that sustain injury during first breeding season will have 100% credit at the next sale at the value of purchase minus \$2,000 salvage value. Contact Lemke Cattle promptly in this event, we usually have replacement bulls available. Breeding season is defined as the 90 day period following the first turnout of a bull.

**VOLUME DISCOUNTS** 2 Bulls -- 2% / 3 Bulls -- 3%  
4 Bulls -- 4% / 5 Bulls -- 5%  
Maximum of 10 Bulls -- 10% Discount

**FEEDING**

The bulls are fed a high roughage ration so they develop, not get fat. Customer feedback has been that the bulls hold up very well.

**ANNOUNCEMENTS**

Any announcements made sale day will take precedence over any information printed in the catalog.

**HEALTH**

All bulls are on a complete health program. Vaccinated with IBR, BVD Type I and II, P13, BRSV, Pasturella, 7-way, Haemophilus, wormed and poured. All bulls have tested negative BVD.  
Stephen Russell, DVM --- 785-527-0594

*All bulls will have passed a fertility test and examination prior to delivery.*

**SALE SUPPLEMENT**

A sale supplement sheet with ultrasound data, scrotal measurements, and yearling weights will be available sale day.

**DELIVERY**

Free delivery of bulls in Nebraska and Northern Kansas, or meet at central locations. Transportation of females is the responsibility of the buyer and must be picked up within two days of the sale. We'll be happy to assist with transportation and females will be fed and cared for until picked up.

**FREE CARE**

Bulls will be fed and cared for at purchaser's risk until April 1st. Bulls may be fed after April 1st at the cost of \$4.00 per head per day. Any bulls picked up within 3 days of sale will have \$100 deducted from the purchase price.

**LIABILITY**

Every precaution will be taken to protect the safety and comfort of those attending the sale. All persons attending the sale do so at their own risk and neither the owner or sale staff assume any responsibility or liability, legal, or otherwise for any accidents occurring in or about the premises.

**SEMEN INTEREST**

Lemke Cattle will retain a 1/3 semen interest in any bull selling. Buyer receives full possession and salvage value.

**EMBRYO TRANSPLANT CALVES**

Embryo Transplant Calves are born to and raised from a recipient cow, therefore the actual birth and weaning weights are not an accurate representation of the calves performance. EPD's give a much more accurate picture of their true genetic potential.

*All bulls have been tested and are free of genetic defects.*

**CALVING EASE STARS** ★★★★★ Absolute Heifer Bull  
★★★★ Larger Heifers or Cows  
★★★ Young and Mature Cows  
★ Mature Cows



### S A V RESOURCE 1441

ANGUS

| R R Rito 707  
**Rito 707 of Ideal 3407 7075**  
 | Ideal 3407 of 1418 076  
 | S A V 8180 Traveler 004  
**S A V Blackcap May 4136**  
 | S A V May 2397

**REG**  
 17016597  
**DOB**  
 1/7/2011  
**TATTOO**  
 1441

CED	BW	WW	YW	SC	CEM	MILK
-1	4.0	69	130	1.08	0	17
MARB	RE	\$W	\$F	\$G	\$B	\$C
-0.09	1.10	52	89	22	111	198



### S A V BLOODLINE 9578

ANGUS

| Coleman Charlo 0256  
**S A V Rainfall 6846**  
 | S A V Blackcap May 4136  
 | S A V 707 Rito 9969  
**S A V Emblynette 2369**  
 | S A V Emblynette 7566

**REG**  
 19542324  
**DOB**  
 12/29/2018  
**TATTOO**  
 9578

CED	BW	WW	YW	SC	CEM	MILK
-7	4.3	77	143	0.57	8	20
MARB	RE	\$W	\$F	\$G	\$B	\$C
0.67	0.40	48	111	54	165	237



### SITZ RESILIENT 10208

ANGUS

| Mohnen Substantial 272  
**Sitz Stellar 726D**  
 | SITZ Pride 200B  
 | Sitz Top Game 561X  
**Sitz Miss Burgess 1856**  
 | Sitz Miss Burgess 4381

**REG**  
 19057457  
**DOB**  
 2/15/2018  
**TATTOO**  
 10208

CED	BW	WW	YW	SC	CEM	MILK
7	0.6	76	132	1.13	5	22
MARB	RE	\$W	\$F	\$G	\$B	\$C
0.98	0.55	80	74	68	134	268



### MOGCK ENTICE

ANGUS

| SydGen Exceed 3223  
**SydGen Enhance**  
 | SydGen Rita 2618  
 | Mogck Sure Shot 253  
**MOGCK Erica 2255**  
 | MOGCK Erica 2162

**REG**  
 18952921  
**DOB**  
 01/31/2017  
**TATTOO**  
 2577

CED	BW	WW	YW	SC	CEM	MILK
2	2.1	77	142	2.21	-4	32
MARB	RE	\$W	\$F	\$G	\$B	\$C
0.81	0.75	76	111	65	176	283

## PIE LONG HAUL 1344

LACY GOLD BAR 8123  
**BIEBER HARD DRIVE Y120**  
 BIEBER LAURA 158W  
 PIE ONE OF A KIND 352  
**PIE RUBY 520**  
 PIE RUBY 381

### RED ANGUS

**REG**  
 4543579  
**DOB**  
 02-26-2021  
**TATTOO**  
 1344

PRO S	HERD	GRID	CED	BW	WW	YW
112	39	73	11	-1.0	86	145
MILK	CEM	STAY	MARB	YG	CW	REA
29	5	13	0.57	-0.09	36	0.54



## PIE CAPTAIN 057

PIE STOCKMAN 4051  
**PIE QUARTERBACK 789**  
 PIE RUBY 520  
 9 MILE FRANCHISE 6305  
**PIE BONNE BEL 852**  
 PIE BONNE BEL 6232

### RED ANGUS

**REG**  
 4388923  
**DOB**  
 01-29-2020  
**TATTOO**  
 057

PRO S	HERD	GRID	CED	BW	WW	YW
91	70	21	14	-5.2	67	108
MILK	CEM	STAY	MARB	YG	CW	REA
39	9	16	0.56	0.04	-1	0.27



## RED MRLA RESOURCE 137E

S A V RESOURCE 1441  
**MRLA RELOAD 56C**  
 RED MRLA MISS 641Y  
 S A V HARVESTOR 0338  
**MRLA MISS 4422B**  
 MRLA MISS 433T

### RED ANGUS

**REG**  
 3897537  
**DOB**  
 02-01-2017  
**TATTOO**  
 137E

PRO S	HERD	GRID	CED	BW	WW	YW
72	42	30	9	2.0	57	99
MILK	CEM	STAY	MARB	YG	CW	REA
21	10	8	0.12	0.22	39	0.05



## RREDS SENECA 731C

BIEBER ROOSEVELT W384  
**BIEBER ROLLIN DEEP Y118**  
 BIEBER TILLY 399W  
 BECKTON EPIC R397 K  
**RREDS ASTER 309A**  
 MLK CRK ASTER 175

### RED ANGUS

**REG**  
 3491307  
**DOB**  
 3/1/2015  
**TATTOO**  
 731C

PRO S	HERD	GRID	CED	BW	WW	YW
69	64	4	11	-2.2	77	123
MILK	CEM	STAY	MARB	YG	CW	REA
19	8	17	0.06	0.18	35	0.43



**OVER 2/3 OF THE OFFERING QUALIFIES!**

**TOP THE  
MARKET**



**LEARN HOW TOP DOLLAR ANGUS HELPS  
QUALIFIED CALVES EARN A  
\$24/HEAD PREMIUM ON AVERAGE AT**

**[TOPDOLLARANGUS.COM/EARNMORE](https://topdollarangus.com/earnmore)**



**NATE SMITH GM  
620.546.4839**

# Semen Available!

Contact Randy Lemke 402-469-2284 or Tanner Lemke 402-984-4596 for more information on these great bulls!

## LEM *Worldwide* 1001 ET #4493743



Sired by PELTON WIDELOAD 78 • Owned by GALL FAMILY RED ANGUS, SD

## LEM *Gladiator* 1039 #1522481



Sired by WERNER FLAT TOP • Owned with LOAN OAK CATTLE, IA

## LEM *Heavy Impact* 1020 #1521573



Sired by MUSGRAVE 316 EXCLUSIVE • Owned with LOAN OAK CATTLE, IA

## LEM *Invasion* 2016 ET #4653529



Sired by PELTON WIDELOAD 78 • Owned with DK RED ANGUS, ND

## LEM *Stockyard* 2001 ET #4659179



Sired by BIEBER CL STOCKMARKET E119 • Owned with ABS GLOBAL



# BLACK HYBRID BULLS



**LOT 1**



DAM OF LOTS 1-4 MS RENOWN 134 ET

## LOTS 1-4 FLUSH BROTHERS

We kickoff this year's offering with this elite flush from a cow family we cannot brag enough about. The LEM MS Renown 134 ET donor & her dam LEM MS Bronc 923 are the models of the type of cow we strive to create; no-holes, moderate-framed, easy-fleshing cows that produce the heaviest calves in the herd. They continuously stamp their progeny with muscle expression, thickness, depth, and performance while maintaining an ideal mature size. There has yet to be a bad daughter from this line and they are easy to pick out among the herd. The cross with Mogck Entice doubled down on the cow-line's calm disposition and performance while increasing carcass merit. Look to these bulls for maternal power to the max and the consistency that is oh-so important for highly-sought after feeder calves.

## Lot 1 LEM ENGAGE 3015 ET

REG: AMGV1583881 | DOB: 12/30/22 | TAT: 3015K | 1.6GV, 98.4AN

SYDGEN ENHANCE

Sire **MOGCK ENTICE**

MOGCK ERICA 2255

S A V RENOWN 3439

Dam **MS RENOWN 134 ET**

LEM MISS BRONC 923

Homozygous Black  
Polled

**ACT BW** **ADJ WW**  
84 722

**CALVING EASE**

★★



CED	BW	WW	YW	MILK	CEM	HP	ST	YG	CW	REA	MARB	FPI
14	0.5	96	167	27	2	8	10	0.18	53	0.36	0.41	97.24
35%	70%	1%	1%	15%	>95%	30%	95%	>95%	10%	85%	30%	2%

Impressive bull that has always risen to the top of a competitive set of black calves. Deep and thick with a calm temperament just like his dam. A bull that should sire calves that excel in all segments of the beef industry.



**Lot 2 LEM ENTICE 3016 ET**



REG: AMGV1583882 | DOB: 12/28/22 | TAT: 3016K | 1.6GV, 98.4AN

SYDGEN ENHANCE

*Sire* **MOGCK ENTICE**

MOGCK ERICA 2255

S A V RENOWN 3439

*Dam* **MS RENOWN 134 ET**

LEM MISS BRONC 923

Homozygous Black  
Polled

<b>ACT BW</b>	<b>ADJ WW</b>
80	666
<b>CALVING EASE</b>	
★★	



CED	BW	WW	YW	MILK	CEM	HP	ST	YG	CW	REA	MARB	FPI
12	-1.5	83	140	27	1	8	16	0.20	62	0.37	0.50	92.43
60%	25%	10%	4%	15%	>95%	30%	30%	>95%	2%	85%	15%	10%

Standout brother from the great flush. Should sire great females just like his dam, grandam, and sisters.



**LOT 2**

**Lot 3 LEM ENTICE 3017 ET**



REG: AMGV1583883 | DOB: 12/27/22 | TAT: 3017K | 1.6GV, 98.4AN

SYDGEN ENHANCE

*Sire* **MOGCK ENTICE**

MOGCK ERICA 2255

S A V RENOWN 3439

*Dam* **MS RENOWN 134 ET**

LEM MISS BRONC 923

Homozygous Black  
Polled

<b>ACT BW</b>	<b>ADJ WW</b>
78	645
<b>CALVING EASE</b>	
★★	



CED	BW	WW	YW	MILK	CEM	HP	ST	YG	CW	REA	MARB	FPI
10	-0.9	86	144	27	0	8	16	0.19	62	0.46	0.50	93.30
85%	35%	5%	2%	15%	>95%	30%	30%	>95%	2%	70%	15%	5%

Good, powerful calf with 12 of his 17 EPDs in the top 35% of the breed or better. Every calf from this flush has met our standard and will do great things.



FULL BROTHER TO THE DAM OF LOTS 1-4 **LEM Bodyguard 1032 ET**  
Selected by Leo Gauderman

**Lot 4 LEM ENTICE 3022 ET**



REG: AMGV1583884 | DOB: 12/28/22 | TAT: 3022K | 1.6GV, 98.4AN

SYDGEN ENHANCE

*Sire* **MOGCK ENTICE**

MOGCK ERICA 2255

S A V RENOWN 3439

*Dam* **MS RENOWN 134 ET**

LEM MISS BRONC 923

Homozygous Black  
Polled

<b>ACT BW</b>	<b>ADJ WW</b>
80	611
<b>CALVING EASE</b>	
★★	



CED	BW	WW	YW	MILK	CEM	HP	ST	YG	CW	REA	MARB	FPI
10	0.2	90	149	27	0	8	11	0.16	62	0.43	0.48	94.24
85%	60%	2%	1%	15%	>95%	30%	90%	>95%	2%	75%	20%	4%

Another good Entice son with a big hip and docility.



**LOT 4**

**ENTICE X MS RENOWN I34**

*Calm Dispositions, Performance, and Carcass Merit!*

## LOTS 5-7 FLUSH BROTHERS

This set of brothers is out of the landmark LEM MS Bronc 923 donor cow. 923 & her progeny have raised the bar in our herd with their elite levels of thickness, maternal strength, and fleshing ability. She is the type of cow you build a foundation upon for generations of future success. This set of calves sired by SAV Bloodline builds on that foundation with added growth and size that is sure to not only leave the front-pasture kind of females, but scale-smashing feeder calves as well.



**LOT 5**



DAM OF LOTS 5-7 LEM MISS BRONC 923

### Lot 5 LEM BLOODLINE 3010 ET

REG: AMGV1583860 | DOB: 12/31/22 | TAT: 3010K | 3.2GV, 96.9AN

S A V RAINFALL 6846

*Sire* S A V BLOODLINE 9578

S A V EMBLYNETTE 2369

BALDRIDGE BRONC

*Dam* LEM MISS BRONC 923

MS CAPITALIST 709 ET

Homozygous Black  
Polled

**ACT BW** **ADJ WW**  
**88** **700**

**CALVING EASE**

★★

**GENESEEEK**  
A Pioneer Legacy

CED	BW	WW	YW	MILK	CEM	HP	ST	YG	CW	REA	MARB	FPI
12	-2.3	77	133	24	9	11	12	0.15	53	0.33	0.49	89.64
60%	15%	25%	10%	40%	15%	10%	85%	>95%	10%	90%	15%	10%

A Bloodline son that has stood out from the pack since birth. Great female making potential.



# MISS BRONC 923

*Thickness, maternal strength, fleshing ability!*

**LOT 6**

## Lot 6 LEM BLOODLINE 3012 ET

REG: AMGV1583862 | DOB: 12/31/22 | TAT: 3012K | 3.2GV, 96.9AN

S A V RAINFALL 6846

Sire S A V BLOODLINE 9578

S A V EMBLYNETTE 2369

BALDRIDGE BRONC

Dam LEM MISS BRONC 923

MS CAPITALIST 709 ET

Homozygous Black Polled

ACT BW	ADJ WW
87	700
CALVING EASE	
★★	



CED	BW	WW	YW	MILK	CEM	HP	ST	YG	CW	REA	MARB	FPI
10	0.8	82	144	24	8	11	11	0.33	54	-0.08	0.63	91.70
85%	75%	15%	2%	40%	25%	10%	90%	>95%	5%	>95%	5%	10%

A powerful and high performing Bloodline son from a potent maternal line.

## Lot 7 LEM BLOODLINE 3011 ET

REG: AMGV1583861 | DOB: 12/31/22 | TAT: 3011K | 3.2GV, 96.9AN

S A V RAINFALL 6846

Sire S A V BLOODLINE 9578

S A V EMBLYNETTE 2369

BALDRIDGE BRONC

Dam LEM MISS BRONC 923

MS CAPITALIST 709 ET

Homozygous Black Polled

ACT BW	ADJ WW
81	617
CALVING EASE	
★★	



CED	BW	WW	YW	MILK	CEM	HP	ST	YG	CW	REA	MARB	FPI
10	-0.4	81	139	24	8	11	16	0.24	60	0.23	0.61	92.10
85%	45%	15%	4%	40%	25%	10%	30%	>95%	2%	95%	10%	10%

Another brother with a solid EPD profile.



## LOTS 8-9 FLUSH BROTHERS

This pair of flush brothers comes from the LEM MS Command 026 ET cow, a daughter of one of the most prolific donors in our history, LEM MS Resource 626D ET, who averaged \$8,030 on 17 sons sold including LEM Heavy Impact 1020 ET to Lone Oak Cattle. The 626 line is known for its explosive performance and power. The 026 cow is a moderate, thick cow with a good udder and phenotype. These bulls should sire desirable feeder calves and powerful replacement females.

**LOT 8**

## Lot 8 LEM BLOODLINE 3014 ET

REG: AMGV1586077 | DOB: 12/26/22 | TAT: 3014K | 2.4GV, 96.9AN, 0.8AR

S A V RAINFALL 6846

Sire S A V BLOODLINE 9578

S A V EMBLYNETTE 2369

BALDRIDGE COMMAND C036

Dam MS COMMAND 026 ET

MS RESOURCE 626D ET

Black Polled

ACT BW	ADJ WW
86	707
CALVING EASE	
★★	



CED	BW	WW	YW	MILK	CEM	HP	ST	YG	CW	REA	MARB	FPI
9	1.4	93	160	22	6	9	11	0.22	62	0.33	0.57	95.66
95%	85%	1%	1%	60%	60%	20%	90%	>95%	2%	90%	10%	3%

Good calf from a powerful cow line. Will sire top feeder calves.

## Lot 9 LEM BLOODLINE 3013 ET

REG: AMGV1586076 | DOB: 1/4/23 | TAT: 3013L | 2.4GV, 96.9AN, 0.8AR

S A V RAINFALL 6846

Sire S A V BLOODLINE 9578

S A V EMBLYNETTE 2369

BALDRIDGE COMMAND C036

Dam MS COMMAND 026 ET

MS RESOURCE 626D ET

Black Polled

ACT BW	ADJ WW
84	704
CALVING EASE	
★★	



CED	BW	WW	YW	MILK	CEM	HP	ST	YG	CW	REA	MARB	FPI
9	1.4	93	160	22	6	9	11	0.22	62	0.33	0.57	95.66
95%	85%	1%	1%	60%	60%	20%	90%	>95%	2%	90%	10%	3%

Will sire moderate, easy keeping daughters like his dam and high performing feeders.

## LOTS 10-13 FLUSH BROTHERS

LEM MS Capitalist 619D ET has made her mark on our herd with the consistent ability to produce heavy-weighting bulls & highly productive daughters. Her first 6 sons, all sired by SAV Resource, have averaged over \$6,000 and consistently fit the same mold of scale-crushing quality that leaves customers happy. Lots 10-13 follow suit and have stood out due to their thickness, power, and maturity since an early age.



**LOT 10**

### Lot 10 LEM RESOURCE 3002 ET

REG: AMGV1583856 | DOB: 1/16/23 | TAT: 3002L | 4.7GV, 93.7AN, 1.7AR

RITO 707 OF IDEAL 3407 7075

Sire **S A V RESOURCE 1441**

S A V BLACKCAP MAY 4136

CONNELY CAPITALIST 028

Dam **MS CAPITALIST 619D ET**

MS BLUESTEM 300 A ET

Homozygous Black  
Polled

ACT BW	ADJ WW
90	809
CALVING EASE	
★★	



CED	BW	WW	YW	MILK	CEM	HP	ST	YG	CW	REA	MARB	FPI
15	-1.3	74	128	21	6	8	18	0.09	55	0.72	0.37	84.39
20%	30%	35%	15%	70%	60%	30%	15%	>95%	4%	20%	35%	30%

The High Weaning bull of the Hybrid offering from a tried and true mating. Thick and powerful calf that should sire pounds in a moderate package.

### Lot 11 LEM RESOURCE 3001 ET

REG: AMGV1583855 | DOB: 1/11/23 | TAT: 3001L | 4.7GV, 93.7AN, 1.7AR

RITO 707 OF IDEAL 3407 7075

Sire **S A V RESOURCE 1441**

S A V BLACKCAP MAY 4136

CONNELY CAPITALIST 028

Dam **MS CAPITALIST 619D ET**

MS BLUESTEM 300 A ET

Homozygous Black  
Polled

ACT BW	ADJ WW
82	646
CALVING EASE	
★★	



CED	BW	WW	YW	MILK	CEM	HP	ST	YG	CW	REA	MARB	FPI
13	0.1	81	138	21	4	8	15	0.02	45	0.57	0.37	86.65
45%	60%	15%	4%	70%	90%	30%	45%	90%	15%	50%	35%	20%

Good son from the reliable mating.



**LOT 12**

**Lot 12 LEM RESOURCE 3005 ET**



REG: AMGV1583859 | DOB: 1/13/23 | TAT: 3005L | 4.7GV, 93.7AN, 1.7AR

RITO 707 OF IDEAL 3407 7075

*Sire* S A V RESOURCE 1441

S A V BLACKCAP MAY 4136

CONNELY CAPITALIST 028

*Dam* MS CAPITALIST 619D ET

MS BLUESTEM 300 A ET

Homozygous Black Polled

ACT BW	ADJ WW
86	686
CALVING EASE	
★★	



CED	BW	WW	YW	MILK	CEM	HP	ST	YG	CW	REA	MARB	FPI
14	0.4	75	125	21	5	8	18	0.25	53	0.16	0.39	82.01
35%	65%	35%	15%	70%	75%	30%	15%	>95%	10%	>95%	30%	40%

Easy fleshing bull with power.

**Lot 13 LEM RESOURCE 3003 ET**

REG: AMGV1583857 | DOB: 1/15/23 | TAT: 3003L | 4.7GV, 93.7AN, 1.7AR

RITO 707 OF IDEAL 3407 7075

*Sire* S A V RESOURCE 1441

S A V BLACKCAP MAY 4136

CONNELY CAPITALIST 028

*Dam* MS CAPITALIST 619D ET

MS BLUESTEM 300 A ET

Homozygous Black Polled

ACT BW	ADJ WW
83	657
CALVING EASE	
★★	



CED	BW	WW	YW	MILK	CEM	HP	ST	YG	CW	REA	MARB	FPI
12	0.5	86	146	21	3	8	14	-0.03	64	0.94	0.31	87.85
60%	70%	5%	2%	70%	95%	30%	60%	80%	1%	4%	50%	15%

Well balanced, homozygous black bull from a consistent pedigree.

**RESOURCE SONS**

*Thickness, power, and scale-crushing quality!*

## LOTS 14-18 FLUSH BROTHERS

LEM MS 316 126 ET is one of the most phenotypic and intriguing young cows in our herd. She exhibits phenomenal length and femininity at an ideal size while hailing from a prominent donor cow herself, LEM MS Charlo 505C ET. We believe 126 and her daughters have a very bright future and will make their mark on our herd. Her SAV Certified sons are standouts in terms of length and sport an added tick of size. They should lead the way in their ability to sire the type of calves that feeders desire. The Sitz Stellar's also offer adequate performance in a soggy, more moderate package that should lead to more calving ease and outstanding replacement females, similar to their excellent dam and flush sisters.



**LOT 14**

### Lot 14 LEM CERTIFIED 3006 ET

REG: AMGV1583877 | DOB: 1/11/23 | TAT: 3006L | 6.25GV, 93.75AN

MARCYS SCALE CRUSHER

Sire S A V CERTIFIED 0849

S A V BLACKCAP MAY 1420

LD CAPITALIST 316

Dam MS 316 126 ET

MS CHARLO 505C ET

Homozygous Black  
Polled

ACT BW	ADJ WW
88	743
CALVING EASE	
★★	



CED	BW	WW	YW	MILK	CEM	HP	ST	YG	CW	REA	MARB	FPI
11	0.1	91	157	23	7	2	12	0.12	70	0.58	0.28	90.09
75%	60%	2%	1%	50%	40%	90%	85%	>95%	1%	45%	55%	10%

Extra long made, high performing bull with an attractive phenotype and out of an excellent donor dam. Will sire outstanding feeder calves.

### Lot 15 LEM CERTIFIED 3009 ET

REG: AMGV1583880 | DOB: 1/24/23 | TAT: 3009L | 6.25GV, 93.75AN

MARCYS SCALE CRUSHER

Sire S A V CERTIFIED 0849

S A V BLACKCAP MAY 1420

LD CAPITALIST 316

Dam MS 316 126 ET

MS CHARLO 505C ET

Black  
Polled

ACT BW	ADJ WW
87	632
CALVING EASE	
★★	



CED	BW	WW	YW	MILK	CEM	HP	ST	YG	CW	REA	MARB	FPI
10	0.3	86	142	23	6	2	13	0.12	69	0.53	0.29	86.53
85%	65%	5%	3%	50%	60%	90%	75%	>95%	1%	55%	50%	20%

Attractive bull with a well-balanced EPD profile.

**Lot 16 LEM STELLAR 3004 ET**



REG: AMGV1583858 | DOB: 1/15/23 | TAT: 3004L | 6.25GV, 93.75AN

MOHNEN SUBSTANTIAL 272

Sire **SITZ STELLAR 726D**

SITZ PRIDE 200B

LD CAPITALIST 316

Dam **MS 316 126 ET**

MS CHARLO 505C ET

Black Polled	
<b>ACT BW</b>	<b>ADJ WW</b>
<b>89</b>	<b>751</b>
<b>CALVING EASE</b>	
★★★	



CED	BW	WW	YW	MILK	CEM	HP	ST	YG	CW	REA	MARB	FPI
12	-1.1	96	162	22	6	3	14	0.25	64	0.47	0.67	103.84
60%	30%	1%	1%	60%	60%	85%	60%	>95%	1%	70%	3%	1%

A bull with a great type and kind. Easy fleshing and out of a fantastic maternal pedigree.



**LOT 16**

**Lot 17 LEM STELLAR 3008 ET**



REG: AMGV1583879 | DOB: 1/26/23 | TAT: 3008L | 6.3GV, 93.8AN

MOHNEN SUBSTANTIAL 272

Sire **SITZ STELLAR 726D**

SITZ PRIDE 200B

LD CAPITALIST 316

Dam **MS 316 126 ET**

MS CHARLO 505C ET

Black Polled	
<b>ACT BW</b>	<b>ADJ WW</b>
<b>80</b>	<b>721</b>
<b>CALVING EASE</b>	
★★	



CED	BW	WW	YW	MILK	CEM	HP	ST	YG	CW	REA	MARB	FPI
12	-0.1	82	136	22	7	3	16	0.23	54	0.42	0.76	96.11
60%	55%	15%	5%	60%	40%	85%	30%	>95%	5%	75%	2%	3%

Another 126 son that will leave great replacement females and offer moderate birth weights.



**LOT 17**

**Lot 18 LEM STELLAR 3007 ET**



REG: AMGV1583878 | DOB: 1/13/23 | TAT: 3007L | 6.3GV, 93.8AN

MOHNEN SUBSTANTIAL 272

Sire **SITZ STELLAR 726D**

SITZ PRIDE 200B

LD CAPITALIST 316

Dam **MS 316 126 ET**

MS CHARLO 505C ET

Black Polled	
<b>ACT BW</b>	<b>ADJ WW</b>
<b>87</b>	<b>627</b>
<b>CALVING EASE</b>	
★★★	



CED	BW	WW	YW	MILK	CEM	HP	ST	YG	CW	REA	MARB	FPI
12	-1.6	84	139	22	7	3	14	0.31	56	0.31	0.59	94.37
60%	25%	10%	4%	60%	40%	85%	60%	>95%	4%	90%	10%	4%

Stout Stellar son with calving ease and female making potential.



**LOT 18**

**ONLINE BIDDING AND VIDEOS** The sale will be broadcast live on DVAuction.com with videos available two weeks prior to the sale. Visit DVAuction.com and register at least 24 hours prior to the sale in order to receive your bidder number.  
For general questions, please contact the office at 402-316-5460.



## LOTS 19-22 FLUSH BROTHERS

This set of Double Wide sons are the commercial cattleman's kind. Their dam, LEM MS Game Babe 732 ET, has always been a standout in terms of power and thickness and is a full sibling to LEM Game Breaker 445B. SAV Double Wide is highly-regarded for his elite length of spine, performance, and overall impressive phenotype.



**LOT 19**



FLUSH BROTHER TO THE DAM OF LOTS 19-22  
**LEM GAME BREAKER 445**

### Lot 19 LEM DOUBLE WIDE 3018 ET

REG: AMGV1583864 | DOB: 1/1/23 | TAT: 3018L | 6.3GV, 93.8AN

S A V ELATION 7899

Sire S A V DOUBLE WIDE 0861

S A V BLACKCAP MAY 1808

GDAR GAME DAY 449

Dam MS GAME BABE 732 ET

MS 031X

Homozygous Black  
Polled

ACT BW	ADJ WW
91	695

CALVING EASE
★★

CED	BW	WW	YW	MILK	CEM	HP	ST	YG	CW	REA	MARB	FPI
11	0.4	81	140	24	1	2	8	0.30	64	0.31	0.31	83.53
75%	65%	15%	4%	40%	>95%	90%	>95%	>95%	1%	90%	50%	30%

Extra heavy made Beef bull. These Double Wide's have lots of length and performance coming from both sides of the pedigree. Lot 19 inherited his heavy body-type from his donor dam, LEM Ms Game Babe 732 ET. 732 is a flush mate to our 2015 High Selling Bull to Mick Lemke, LEM Game Breaker 445 ET, who is one of the stoutest and thickest beef bulls we've ever produced.





**Lot 20 LEM DOUBLE WIDE 3061 ET**



REG: AMGV1583867 | DOB: 1/6/23 | TAT: 3061L | 6.3GV, 93.8AN

S A V ELATION 7899

*Sire* S A V DOUBLE WIDE 0861

S A V BLACKCAP MAY 1808

GDAR GAME DAY 449

*Dam* MS GAME BABE 732 ET

MS 031X

Homozygous Black  
Polled

ACT BW	ADJ WW
88	619
CALVING EASE	
★★	



CED	BW	WW	YW	MILK	CEM	HP	ST	YG	CW	REA	MARB	FPI
14	-3.2	70	114	24	3	2	11	0.18	63	0.52	0.37	83.56
35%	10%	55%	35%	40%	95%	90%	90%	>95%	2%	60%	35%	30%



REFERENCE SIRE S A V DOUBLE WIDE 0861

**Lot 21 LEM DOUBLE WIDE 3020 ET**



REG: AMGV1583866 | DOB: 1/5/23 | TAT: 3020L | 6.3GV, 93.8AN

S A V ELATION 7899

*Sire* S A V DOUBLE WIDE 0861

S A V BLACKCAP MAY 1808

GDAR GAME DAY 449

*Dam* MS GAME BABE 732 ET

MS 031X

Homozygous Black  
Polled

ACT BW	ADJ WW
84	602
CALVING EASE	
★★	



CED	BW	WW	YW	MILK	CEM	HP	ST	YG	CW	REA	MARB	FPI
15	-2.6	82	139	24	3	2	10	0.18	60	0.42	0.53	94.82
20%	10%	15%	4%	40%	95%	90%	95%	>95%	2%	75%	15%	4%

**Lot 22 LEM DOUBLE WIDE 3019 ET**



REG: AMGV1583865 | DOB: 1/8/23 | TAT: 3019L | 6.3GV, 93.8AN

S A V ELATION 7899

*Sire* S A V DOUBLE WIDE 0861

S A V BLACKCAP MAY 1808

GDAR GAME DAY 449

*Dam* MS GAME BABE 732 ET

MS 031X

Black  
Polled

ACT BW	ADJ WW
86	614
CALVING EASE	
★★	



CED	BW	WW	YW	MILK	CEM	HP	ST	YG	CW	REA	MARB	FPI
14	-1.1	79	133	24	3	2	10	0.25	61	0.28	0.44	88.45
35%	30%	20%	10%	40%	95%	90%	95%	>95%	2%	95%	25%	15%

**Lot 23 LEM RAMPAGE 3052**

REG: AMGV1583191 | DOB: 12/27/22 | TAT: 3052K | 6.3GV, 93.8AN

RITO 707 OF IDEAL 3407 7075

*Sire* S A V RESOURCE 1441

S A V BLACKCAP MAY 4136

CONNELLY CAPITALIST 028

*Dam* MS RESOURCE 827 ET

MS NET WORTH 341 A

Homozygous Black  
Polled

ACT BW	ADJ WW
84	716
CALVING EASE	
★★	



CED	BW	WW	YW	MILK	CEM	HP	ST	YG	CW	REA	MARB	FPI
9	3.6	91	154	21	2	6	9	0.05	72	0.81	0.31	86.16
95%	>95%	2%	1%	70%	>95%	50%	>95%	95%	1%	15%	50%	20%

Super powerful bull that stands among the top of the offering. No surprise that he's sired by Resource and out of an impressive 341 daughter.



LOT 18

**DNA & Ultrasound Data with Decades of A.I. & E.T.!**  
**First Breeding Season Guarantee / Free Care Until April 1 and Free Delivery**



**LOT 24**

**Lot 24 LEM BLOODLINE 3053**

REG: AMGV1583194 | DOB: 12/28/22 | TAT: 3053K | 14.9GV, 84.2AN, 1AR

S A V RAINFALL 6846

*Sire* S A V BLOODLINE 9578

S A V EMBLYNETTE 2369

BALDRIDGE COMMAND C036

*Dam* MS COMMAND 959

MS SILVER 735 ET

Homozygous Black  
Polled

ACT BW 88 ADJ WW 690

CALVING EASE  
★★



CED	BW	WW	YW	MILK	CEM	HP	ST	YG	CW	REA	MARB	FPI
9	0.5	86	143	21	6	9	12	0.13	54	0.38	0.47	90.17
95%	70%	5%	3%	70%	60%	20%	85%	>95%	5%	85%	20%	10%

High performing Bloodline son that's a maternal brother to 2022 Sale Feature, LEM Gladiator 1039.



**LOT 25**

**Lot 25 LEM BLOODLINE 3058**

REG: AMGV1583998 | DOB: 12/16/22 | TAT: 3058K | 15.7GV, 84.4AN

S A V RAINFALL 6846

*Sire* S A V BLOODLINE 9578

S A V EMBLYNETTE 2369

GAME BREAKER 445B

*Dam* MS GAME BREAKER 708 ET

MS FRONTIER 932W

Homozygous Black  
Polled

ACT BW 89 ADJ WW 606

CALVING EASE  
★★



CED	BW	WW	YW	MILK	CEM	HP	ST	YG	CW	REA	MARB	FPI
9	1.7	84	150	21	7	7	13	0.20	58	0.25	0.78	95.37
95%	90%	10%	1%	70%	40%	40%	75%	>95%	3%	95%	1%	3%

Extra growth and carcass traits in this Bloodline son with Top 1% YW & MARB.



MATERNAL BROTHER TO LOT 24 LEM GLADIATOR 1039

**Lot 26 LEM DOUBLE WIDE 3054**

REG: AMGV1583825 | DOB: 12/20/22 | TAT: 3054K | 6.3GV, 93.8AN

S A V ELATION 7899

*Sire* S A V DOUBLE WIDE 0861

S A V BLACKCAP MAY 1808

S A V RESOURCE 1441

*Dam* MS RESOURCE 913 ET

MS CAP 623D ET

Homozygous Black  
Polled

ACT BW 87 ADJ WW 633

CALVING EASE  
★★



CED	BW	WW	YW	MILK	CEM	HP	ST	YG	CW	REA	MARB	FPI
12	0.2	76	132	21	1	2	12	0.26	61	0.42	0.32	81.29
60%	60%	30%	10%	70%	>95%	90%	85%	>95%	2%	75%	45%	40%

Well balanced Double Wide son from a Resource cow with extra power.

**Lot 27 LEM BLOODLINE 3060**



REG: AMGV1583192 | DOB: 12/27/22 | TAT: 3060K | 12.5GV, 87.5AN

S A V RAINFALL 6846

*Sire* S A V BLOODLINE 9578

S A V EMBLYNETTE 2369

RANSOM 777 ET

*Dam* 954

MS BRILLIANCE 304 A

Homozygous Black  
Polled

ACT BW	ADJ WW
89	611
CALVING EASE	
★★	



CED	BW	WW	YW	MILK	CEM	HP	ST	YG	CW	REA	MARB	FPI
8	2.4	81	139	18	6	7	8	0.21	59	0.19	0.47	84.13
>95%	95%	15%	4%	90%	60%	40%	>95%	>95%	3%	>95%	20%	30%

Great phenotype. Will add length and performance to feeder cattle.



**LOT 27**

**Lot 28 LEM BLOODLINE 3041**



REG: AMGV1583193 | DOB: 1/16/23 | TAT: 3041L | 12.5GV, 87.5AN

S A V RAINFALL 6846

*Sire* S A V BLOODLINE 9578

S A V EMBLYNETTE 2369

PA FULL POWER 1208

*Dam* MS FULL POWER 719 ET

MS NET WORTH 210 Z ET

Homozygous Black  
Polled

ACT BW	ADJ WW
89	782
CALVING EASE	
★★	



CED	BW	WW	YW	MILK	CEM	HP	ST	YG	CW	REA	MARB	FPI
9	0.4	87	151	25	6	3	13	0.22	62	0.20	0.66	95.93
95%	65%	4%	1%	30%	60%	85%	75%	>95%	2%	>95%	4%	3%

Standout type of bull since birth. Square-made power bull with an actual WW of 800lb. Beautiful dam has raised several herd bulls.



**LOT 28**

**Lot 29 LEM BLOODLINE 3028**



REG: AMGV1583184 | DOB: 1/10/23 | TAT: 3028L | 9.4GV, 87.3AN, 3.1AR

S A V RAINFALL 6846

*Sire* S A V BLOODLINE 9578

S A V EMBLYNETTE 2369

BUFORD BLUESTEM 9974

*Dam* MS BLUESTEM 300 A ET

MS FRONTIER 039X ET

Homozygous Black  
Polled

ACT BW	ADJ WW
86	744
CALVING EASE	
★★	



CED	BW	WW	YW	MILK	CEM	HP	ST	YG	CW	REA	MARB	FPI
11	0.6	91	152	24	9	7	14	0.28	58	0.11	0.72	99.42
75%	70%	2%	1%	40%	15%	40%	60%	>95%	3%	>95%	2%	1%

Out of the 300 Donor Dam who has left a tremendous mark on our program having produced many replacement females, including 3 donor daughters, and 22 sons sold prior to this one. 3028 is another high performing Bloodline with an impressive number set.



**LOT 29**



**LOT 31**



MATERNAL BROTHER TO LOT 31 **LEM DEEP IMPACT 0404**



MATERNAL BROTHER TO LOT 31 **LEM REVIVAL 2049**

**Lot 30 LEM EMPIRE 3031**



REG: AMGV1583195 | DOB: 1/7/23 | TAT: 3031L | 18.75GV, 81.25AN

CONNEALY CAPITALIST 028

*Sire* **EMPIRE 677D ET**

MS NET WORTH 341 A

BUFORD BLUESTEM 9974

*Dam* **MS BLUESTEM 416B ET**

MS FRONTIER 736T

Homozygous Black  
Polled  
**ACT BW** 84 **ADJ WW** 708  
**CALVING EASE**  
★★



CED	BW	WW	YW	MILK	CEM	HP	ST	YG	CW	REA	MARB	FPI
12	2.0	78	123	28	6	4	16	0.04	51	0.58	0.35	81.71
60%	95%	25%	20%	10%	60%	75%	30%	95%	10%	45%	40%	40%

Balanced calf with a balanced EPD profile.

**Lot 31 LEM BLOODLINE 3040**



REG: AMGV1583188 | DOB: 1/16/23 | TAT: 3040L | 9.4GV, 87.5AN, 3.1AR

S A V RAINFALL 6846

*Sire* **S A V BLOODLINE 9578**

S A V EMBLYNETTE 2369

CONNEALY CAPITALIST 028

*Dam* **MS CAPITAL 717 ET**

MS FRONTIER 039X ET

Homozygous Black  
Polled  
**ACT BW** 86 **ADJ WW** 717  
**CALVING EASE**  
★★



CED	BW	WW	YW	MILK	CEM	HP	ST	YG	CW	REA	MARB	FPI
9	1.9	81	138	21	6	7	15	0.22	54	-0.02	0.89	95.60
95%	90%	15%	4%	70%	60%	40%	45%	>95%	5%	>95%	1%	3%

A maternal brother to the High Selling Black bulls of both the 2021 and 2023 sales, LEM Deep Impact 0404 ET and LEM Revival 2049 ET. The Capitalist 717 cow has had 13 sons sell for an average of over \$7,300 and has consistently produced quality in her calves that is easy to pick out in the pasture.

### Lot 32 LEM EXPEDITION 3035



REG: AMGV1585670 | DOB: 1/17/23 | TAT: 3035L | 12.5GV, 81.25AN, 6.25XX

T K EXPEDITION F729

Sire T K EXPEDITION H282

T K MADGE F651

S A V RESOURCE 1441

Dam MS RESOURCE 729 ET

MS MIDLAND 823U

Black Polled	
ACT BW	ADJ WW
89	702
CALVING EASE	
★★	



CED	BW	WW	YW	MILK	CEM	HP	ST	YG	CW	REA	MARB	FPI
11	0.8	87	144	27	3	1	11	0.06	58	0.58	0.45	91.56
75%	75%	4%	2%	15%	95%	95%	90%	95%	3%	45%	20%	10%

Expedition son with good growth and carcass traits from a great ordered Resource daughter that knows how to raise power bulls.

### Lot 33 LEM RESILIENT 3033



REG: AMGV1583186 | DOB: 1/13/23 | TAT: 3033L | 15.7GV, 84.4AN

SITZ STELLAR 726D

Sire SITZ RESILIENT 10208

SITZ MISS BURGESS

GAME BREAKER 445B

Dam MS GAME BREAKER 734 ET

MS FRONTIER 932W

Black Polled	
ACT BW	ADJ WW
72	672
CALVING EASE	
★★★★	



CED	BW	WW	YW	MILK	CEM	HP	ST	YG	CW	REA	MARB	FPI
18	-0.5	77	127	25	8	1	14	0.06	39	0.51	0.59	91.94
4%	45%	25%	15%	30%	25%	95%	60%	95%	30%	60%	10%	10%

Heifer bull with an impressive EPD profile. Easy fleshing, deep bodied dam is a model cow.

### Lot 34 LEM BLOODLINE 3026



REG: AMGV1583183 | DOB: 1/14/23 | TAT: 3026L | 4.7GV, 93.7AN, 1.7AR

S A V RAINFALL 6846

Sire S A V BLOODLINE 9578

S A V EMBLYNETTE 2369

CONNEALY CAPITALIST 028

Dam FAITH 500C ET

MS BLUESTEM 300 A ET

Homozygous Black Polled	
ACT BW	ADJ WW
87	679
CALVING EASE	
★★	



CED	BW	WW	YW	MILK	CEM	HP	ST	YG	CW	REA	MARB	FPI
10	-1.0	78	126	23	7	8	13	0.10	47	0.34	0.48	87.57
85%	35%	25%	15%	50%	40%	30%	75%	>95%	15%	90%	20%	20%

Standout among his contemporaries. Dam is a tremendous brood cow that is extremely deep, has a great disposition, and tidy udder.



LOT 34

### Lot 35 LEM DOUBLE WIDE 3034



REG: AMGV1583822 | DOB: 1/17/23 | TAT: 3034L | 7.8GV, 90.2AN, 2AR

S A V ELATION 7899

Sire S A V DOUBLE WIDE 0861

S A V BLACKCAP MAY 1808

DENSITY 564C ET

Dam MS REPUTATION 704

MS FINAL ANSWER 204 Z

Homozygous Black Polled	
ACT BW	ADJ WW
88	705
CALVING EASE	
★★★	



CED	BW	WW	YW	MILK	CEM	HP	ST	YG	CW	REA	MARB	FPI
15	-1.8	74	128	22	4	2	18	0.23	67	0.47	0.49	87.83
20%	20%	35%	15%	60%	90%	90%	15%	>95%	1%	70%	15%	15%

Performance in this Double Wide son.

### Lot 36 LEM INFINITY 3029



REG: AMGV1583185 | DOB: 1/15/23 | TAT: 3029L | 31.3GV, 68.7AN

TAU MR IN FOCUS 22Z

Sire INFINITY 47C

TAU MIA 363A

BALDRIDGE COMMAND C036

Dam MS COMMAND 023 ET

MS RESOURCE 825 ET

Homozygous Black Polled	
ACT BW	ADJ WW
89	713
CALVING EASE	
★★	



CED	BW	WW	YW	MILK	CEM	HP	ST	YG	CW	REA	MARB	FPI
9	0.7	77	123	27	1	13	15	-0.11	40	0.82	0.52	86.95
95%	75%	30%	25%	15%	>95%	2%	40%	35%	40%	10%	20%	25%

Thick and moderate Infinity son. Tremendous cow behind him.

### Lot 37 LEM EXPEDITION 3027

REG: AMGV1588620 | DOB: 2/5/23 | TAT: 3027 | 4.7% GV, 87.4% AN, 1.7% AR, 6.3% XX

T K EXPEDITION F729

Sire T K EXPEDITION H282

T K MADGE F651

S A V RESOURCE 1441

Dam MS RESOURCE 822 ET

MS BLUESTEM 300 A ET

CED	BW	WW	YW	MILK	CEM	HP	ST	YG	CW	REA	MARB	FPI
12	0.7	89	144	28	4	4.94	12	0.10	59	0.48	0.50	94.31
60%	75%	3%	2%	10%	90%	60%	85%	>95%	3%	65%	15%	4%

Black Polled

ACT BW	ADJ WW
83	702

CALVING EASE



### Lot 38 LEM DOUBLE WIDE 3032

REG: AMGV1583821 | DOB: 1/13/23 | TAT: 3032L | 2.4GV, 96.9AN, 0.8AR

S A V ELATION 7899

Sire S A V DOUBLE WIDE 0861

S A V BLACKCAP MAY 1808

BALDRIDGE COMMAND C036

Dam MS COMMAND 027 ET

MS RESOURCE 626D ET

CED	BW	WW	YW	MILK	CEM	HP	ST	YG	CW	REA	MARB	FPI
12	-0.5	89	150	22	1	7	12	0.26	66	0.48	0.53	94.91
60%	45%	3%	1%	60%	>95%	40%	85%	>95%	1%	65%	15%	4%

Homozygous Black Polled

ACT BW	ADJ WW
80	708

CALVING EASE  
★★



Top growth and carcass EPDs. From a moderate, efficient dam with a perfect udder.

### Lot 39 LEM DOUBLE WIDE 3036

REG: AMGV1583823 | DOB: 1/13/23 | TAT: 3036L | 2.4GV, 96.9AN, 0.8AR

S A V ELATION 7899

Sire S A V DOUBLE WIDE 0861

S A V BLACKCAP MAY 1808

S A V RESOURCE 1441

Dam MS RESOURCE 922 ET

MS CAPITALIST 619D ET

CED	BW	WW	YW	MILK	CEM	HP	ST	YG	CW	REA	MARB	FPI
12	1.7	93	163	18	1	7	14	0.30	65	0.26	0.38	90.93
60%	90%	1%	1%	90%	>95%	40%	60%	>95%	1%	95%	35%	10%

Homozygous Black Polled

ACT BW	ADJ WW
90	692

CALVING EASE  
★★



Double Wide son from an attractive Resource daughter.

### Lot 40 LEM COMMAND 3043

REG: AMGV1583190 | DOB: 1/17/23 | TAT: 3043L | 25GV, 75AN

EF COMMANDO 1366

Sire BALDRIDGE COMMAND C036

BALDRIDGE BLACKBIRD A030

MR GOLDRUSH U303

Dam MISS 401B

MISS 555R

CED	BW	WW	YW	MILK	CEM	HP	ST	YG	CW	REA	MARB	FPI
18	-2.1	55	85	27	8	8	15	0.04	39	0.50	0.54	79.16
5%	20%	>95%	>95%	15%	30%	25%	40%	90%	40%	55%	15%	65%

Homozygous Black Polled

ACT BW	ADJ WW
80	615

CALVING EASE  
★★★★



Heifer bull with extra carcass and maternal traits. 10 year-old dam has a great udder.



DAM OF LOT 41 MS RENOWN 134 ET

### Lot 41 LEM FLAT TOP 3038

REG: AMGV1583187 | DOB: 1/18/23 | TAT: 3038L | 1.6GV, 98.4AN

CONNEALY BLACK GRANITE

Sire WERNER FLAT TOP 4136

WERNER LADY 0304

S A V RENOWN 3439

Dam MS RENOWN 134 ET

LEM MISS BRONC 923

CED	BW	WW	YW	MILK	CEM	HP	ST	YG	CW	REA	MARB	FPI
16	-2.8	72	127	29	7	12	14	-0.02	34	0.43	0.43	88.47
15%	10%	45%	15%	10%	40%	5%	60%	85%	45%	75%	25%	15%

Homozygous Black Polled

ACT BW	ADJ WW
71	641

CALVING EASE  
★★★★



Maternal brother to lots 1-4. Calving ease son of the elite donor cow.



# BLACK ANGUS BULLS



**LOT 42**

## Lot 42 LEM RESILIENT 3047 ET

REG: AAA 20795041 | DOB: 01/01/23 | TAT: 3047 | 100% AN

Sitz Stellar 726D

*Sire* Sitz Resilient 10208

Sitz Miss Burgess 1856

S A V Resource 1441

*Dam* Lem Miss Kitty 146 Et

MS Capitalist 642 Et

ACT BW	ADJ WW
77	728
CALVING EASE	
★★	



CED	BW	WW	YW	MILK	CEM	SEN	CW	MARB	RE	FAT
4	0.5	66	108	29	7	2	44	0.39	0.53	0.037
70%	35%	45%	60%	30%	65%	15%	65%	80%	70%	80%
SM	SW	SF	SG	SB	SC					
92	75	83	36	120	248					
2%	15%	60%	80%	80%	55%					

Standout Angus bull with great phenotype, structure, and feet. Sisters are moderate thick females that we are excited about.

## LOTS 42-45 FLUSH BROTHERS

This set of ET brothers has given us excitement as we look to grow our Angus footprint. Their dam, LEM Miss Kitty 146 ET, was an exciting young female before we, unfortunately, lost her at an early age. Thankfully we had done this flush to Sitz Resilient that will build upon their mother's potential. These bulls are well balanced, thick individuals that have stood out among the entire offering since a young age. We really like their maternal pedigree backed by two breed leading female-producing sires, SAV Resource and Sitz Resilient.



**Lof 43 LEM RESILIENT 3044 ET**

REG: AAA 20795040 | DOB: 01/04/23 | TAT: 3044 | 100% AN

Sitz Stellar 726D

*Sire* Sitz Resilient 10208

Sitz Miss Burgess 1856

S A V Resource 1441

*Dam* Lem Miss Kitty 146 Et

MS Capitalist 642 Et

ACT BW	ADJ WW
74	706
CALVING EASE	
★★★	



CED	BW	WW	YW	MILK	CEM	SEN	CW	MARB	RE	FAT
6	2.0	74	138	31	8	-17	59	0.69	0.77	0.019
55%	70%	25%	15%	20%	55%	55%	30%	50%	35%	60%
SM	SW	SF	SG	SB	SC					
82	73	97	56	153	280					
10%	15%	30%	40%	40%	25%					

Resilient son that has always stood among the top bulls in the offering. Good performance and maternal pedigree. Balanced EPD package

LOT 43



SIRE OF LOTS 42-45 SITZ RESILIENT 10208

**Lof 44 LEM RESILIENT 3046 ET**

REG: AAA 20795025 | DOB: 01/01/23 | TAT: 3046 | 100% AN

Sitz Stellar 726D

*Sire* Sitz Resilient 10208

Sitz Miss Burgess 1856

S A V Resource 1441

*Dam* Lem Miss Kitty 146 Et

MS Capitalist 642 Et

ACT BW	ADJ WW
72	645
CALVING EASE	
★★	



CED	BW	WW	YW	MILK	CEM	SEN	CW	MARB	RE	FAT
1	2.1	73	127	32	5	-17	54	0.56	0.71	0.034
90%	70%	25%	25%	15%	85%	55%	40%	65%	40%	80%
SM	SW	SF	SG	SB	SC					
78	75	93	47	140	260					
15%	15%	40%	60%	55%	40%					

Another member of a good set of flush brothers.

**Lof 45 LEM RESILIENT 3045 ET**

REG: AAA 20795024 | DOB: 01/05/23 | TAT: 3045 | 100% AN

Sitz Stellar 726D

*Sire* Sitz Resilient 10208

Sitz Miss Burgess 1856

S A V Resource 1441

*Dam* Lem Miss Kitty 146 Et

MS Capitalist 642 Et

ACT BW	ADJ WW
76	634
CALVING EASE	
★★	



CED	BW	WW	YW	MILK	CEM	SEN	CW	MARB	RE	FAT
2	2.4	77	132	30	2	-16	66	0.73	0.78	0.032
85%	75%	15%	20%	25%	95%	55%	15%	45%	30%	75%
SM	SW	SF	SG	SB	SC					
80	77	110	57	168	298					
15%	10%	15%	40%	25%	15%					

Attractive calf with growth and carcass merit.

LOT 45

**RESILIENT X KITTY 146**

*Balanced bulls with a maternal pedigree!*



**Lot 46 LEM CERTIFIED 3048 ET**

REG: AAA 20795026 | DOB: 01/04/23 | TAT: 3048 | 100% AN

Marcys Scale Crusher

*Sire* S A V Certified 0849

S A V Blackcap May 1420

S A V Rainfall 6846

*Dam* Lem Lady Landmark 139 Et

Lem MS Aviator 926 Et

ACT BW	ADJ WW
80	696
CALVING EASE	
★	



REFERENCE SIRE S A V CERTIFIED 0849

CED	BW	WW	YW	MILK	CEM	SEN	CW	MARB	RE	FAT
-11	6.3	87	151	17	1	-37	72	0.06	0.81	-0.043
95%	95%	4%	5%	95%	95%	95%	10%	95%	30%	3%
SM	SW	SF	SG	SB	SC					
45	53	114	29	143	230					
95%	70%	10%	90%	50%	70%					

A nice Certified son from a growthy young Rainfall daughter.

**LOTS 47-48 FLUSH BROTHERS**

A pair of Bloodline sons with added frame from a tidy uddered Exclusive daughter.

**Lot 47 LEM BLOODLINE 3055 ET**

REG: AAA 20795028 | DOB: 01/07/23 | TAT: 3055 | 100% AN

S A V Rainfall 6846

*Sire* S A V Bloodline 9578

S A V Emblynette 2369

Musgrave 316 Exclusive

*Dam* Lem Forever Lady 138 Et

T/D Forever Lady 9185

ACT BW	ADJ WW
86	658
CALVING EASE	
★★	



MATERNAL GRANDSIRE TO LOTS 47-48 MUSGRAVE 316 EXCLUSIVE

CED	BW	WW	YW	MILK	CEM	SEN	CW	MARB	RE	FAT
-2	4.1	80	147	27	10	-55	73	0.98	0.49	0.02
95%	95%	10%	10%	45%	35%	95%	10%	25%	75%	60%
SM	SW	SF	SG	SB	SC					
43	58	119	67	186	284					
95%	55%	5%	25%	10%	20%					

**Lot 48 LEM BLOODLINE 3049 ET**

REG: AAA 20795027 | DOB: 01/06/23 | TAT: 3049 | 100% AN

S A V Rainfall 6846

*Sire* S A V Bloodline 9578

S A V Emblynette 2369

Musgrave 316 Exclusive

*Dam* Lem Forever Lady 138 Et

T/D Forever Lady 9185

ACT BW	ADJ WW
84	651
CALVING EASE	
★★	



LOT 48

CED	BW	WW	YW	MILK	CEM	SEN	CW	MARB	RE	FAT
2	1.5	78	140	26	12	-36	61	0.6	0.64	0.009
85%	60%	15%	15%	55%	20%	95%	25%	60%	55%	45%
SM	SW	SF	SG	SB	SC					
65	70	106	51	156	267					
50%	20%	20%	50%	35%	35%					



**Lot 49 LEM RESOURCE 3059**

REG: AAA 20795038 | DOB: 01/01/23 | TAT: 3059 | 100% AN

Rito 707 of Ideal 3407 7075

*Sire* S A V Resource 1441

S A V Blackcap May 4136

EXAR Denver 2002B

*Dam* MS Denver 6104 Et

B/F Forever Lady 46P 7P 104T

<b>ACT BW</b>	<b>ADJ WW</b>
84	811
<b>CALVING EASE</b>	
★★	



CED	BW	WW	YW	MILK	CEM	SEN	CW	MARB	RE	FAT
-1	3.3	67	111	24	5	-8	45	0.18	0.74	-0.01
95%	90%	40%	55%	70%	85%	35%	65%	95%	40%	25%
SM	SW	SF	SG	SB	SC					
77	61	85	32	117	229					
20%	45%	55%	90%	85%	75%					

Thick and powerful Angus Resource son that has always been a standout.

**Lot 50 LEM CERTIFIED 3051**

REG: AAA 20795037 | DOB: 01/13/23 | TAT: 3051 | 100% AN

Marcys Scale Crusher

*Sire* S A V Certified 0849

S A V Blackcap May 1420

Musgrave Aviator

*Dam* Lem MS Aviator 926 Et

MS Capitalist 642 Et

<b>ACT BW</b>	<b>ADJ WW</b>
86	677
<b>CALVING EASE</b>	
★★	



CED	BW	WW	YW	MILK	CEM	SEN	CW	MARB	RE	FAT
7	0.7	61	119	18	14	-20	57	-0.24	1.07	-0.054
45%	40%	60%	40%	95%	10%	65%	35%	95%	10%	1%
SM	SW	SF	SG	SB	SC					
42	48	111	18	129	209					
95%	85%	15%	95%	70%	90%					

High performance Certified son out of the 926 cow who has an impressive set of Resource sons on last year's sale.

**Lot 51 LEM DOUBLE WIDE 3037**

REG: AAA 20849434 | DOB: 01/15/23 | TAT: 3037 | 100% AN

S A V Elation 7899

*Sire* S A V Double Wide 0861

S A V Blackcap May 1808

E&b Impression 380

*Dam* MS Impression 513

E&b Lady 8021 in Focus 215

<b>ACT BW</b>	<b>ADJ WW</b>
90	703
<b>CALVING EASE</b>	
★★	



CED	BW	WW	YW	MILK	CEM	SEN	CW	MARB	RE	FAT
6	1.5	60	107	23	6	-14	48	0.68	0.6	0.017
55%	60%	60%	60%	75%	75%	50%	55%	50%	60%	55%
SM	SW	SF	SG	SB	SC					
45	50	93	53	146	234					
95%	80%	40%	45%	50%	70%					

Double Wide son with lots of performance and out of a very attractive, great uddered cow.



REFERENCE SIRE S A V CERTIFIED 0849



REFERENCE SIRE S A V DOUBLE WIDE 0861



# RED ANGUS BULLS



**LOT 52**

## Lot 52 LEM AUTOMATIC 3065 ET

REG: RAAA 4835974 | DOB: 01-20-2023 | TAT: 3065 | 100% AR

MRLA RELOAD 56C

*Sire* RED MRLA RESOURCE 137E

MRLA MISS 4422B

RREDS SENECA 731C

*Dam* LEM MS SENECA 902 ET

LEM REDEMPTION 616 ET

ACT BW	ADJ WW
82	774
CALVING EASE	
★★	



PRO S	HERD	GRID	CED	BW	WW	YW	MILK	CEM	HP
73	60	13	10	-0.5	59	100	21	7	15
77%	33%	93%	88%	76%	58%	45%	88%	45%	8%
ST	YG	CW	REA	MARB	FAT				
15	0.13	32	0.16	0.03	0.04				
46%	82%	21%	45%	99%	81%				

Standout in the pasture all summer. Heavy built with bone, thickness, and power on a great set of feet and legs. Pairs the power of his sire, Resource, with the maternal superiority and fertility of his elite donor dam, 902. Performance in an ideal sized package. Will be collected and used back in our program.

## LOTS 52-56 FLUSH BROTHERS

Another set of impressive sons from the elite LEM MS Seneca 902 ET donor cow. She has consistently led the way for our Red Angus herd with powerful, fertile, and sound progeny that check lots of boxes. Her first 2 sets of calves consisted of 13 bulls that averaged over \$9,200 including our all-time high seller, LEM Worldwide 1001 ET, selected by Gall Family Red Angus. This set of sons carries that standard forward, sired by a bull with a legacy of his own in the Red Angus breed, Red MRLA Resource 137E.

*A standout all summer!*



DAM OF LOTS 52-56 **LEM MS SENECA 902 ET**



SIRE OF LOTS 52-56 **RED MRLA RESOURCE 137E**



**Lot 53 LEM RESOURCE 3066 ET**

REG: RAAA 4835976 | DOB: 01-23-2023 | TAT: 3066 | 100% AR

MRLA RELOAD 56C

*Sire* **RED MRLA RESOURCE 137E**

MRLA MISS 4422B

RREDS SENECA 731C

*Dam* **LEM MS SENECA 902 ET**

LEM REDEMPTION 616 ET

<b>ACT BW</b>	<b>ADJ WW</b>
80	703
<b>CALVING EASE</b>	
★★	



PRO S	HERD	GRID	CED	BW	WW	YW	MILK	CEM	HP
94	65	29	10	-1.4	58	101	21	8	15
44%	24%	70%	85%	60%	62%	43%	88%	30%	8%
ST	YG	CW	REA	MARB	FAT				
16	0.16	37	0.26	0.12	0.05				
39%	90%	9%	25%	98%	94%				

Another really impressive Resource son just like Lot 52, but with a darker red coat color. Very balanced and attractive calf.

**Lot 54 LEM RESOURCE 3067 ET**

REG: RAAA 4835978 | DOB: 01-26-2023 | TAT: 3067 | 100% AR

BIEBER HARD DRIVE Y120

*Sire* **PIE LONG HAUL 1344**

PIE RUBY 520

PELTON WIDELOAD 78B

*Dam* **LEM GINGER 116 ET**

LEM MS SENECA 902 ET

<b>ACT BW</b>	<b>ADJ WW</b>
81	660
<b>CALVING EASE</b>	
★★	



PRO S	HERD	GRID	CED	BW	WW	YW	MILK	CEM	HP
95	37	58	11	-1.2	75	120	27	4	13
41%	77%	15%	78%	64%	9%	11%	43%	93%	22%
ST	YG	CW	REA	MARB	FAT				
14	0.04	39	0.44	0.54	0.02				
57%	34%	7%	6%	25%	55%				

**Lot 55 LEM RESOURCE 3068 ET**

REG: RAAA 4835980 | DOB: 01-17-2023 | TAT: 3068 | 100% AR

MRLA RELOAD 56C

*Sire* **RED MRLA RESOURCE 137E**

MRLA MISS 4422B

RREDS SENECA 731C

*Dam* **LEM MS SENECA 902 ET**

LEM REDEMPTION 616 ET

<b>ACT BW</b>	<b>ADJ WW</b>
83	628
<b>CALVING EASE</b>	
★★	



PRO S	HERD	GRID	CED	BW	WW	YW	MILK	CEM	HP
97	73	24	12	0.1	68	113	21	9	15
38%	13%	78%	64%	84%	25%	19%	88%	20%	8%
ST	YG	CW	REA	MARB	FAT				
16	0.19	29	0.01	0.22	0.04				
33%	95%	30%	77%	92%	90%				

**MATERNAL BROTHERS**

*to our all-time high seller, Worldwide!*



**Lot 56 LEM RESOURCE 3069 ET**

REG: RAAA 4835982 | DOB: 01-15-2023 | TAT: 3069 | 100% AR

MRLA RELOAD 56C

*Sire* RED MRLA RESOURCE 137E

MRLA MISS 4422B

RREDS SENECA 731C

*Dam* LEM MS SENECA 902 ET

LEM REDEMPTION 616 ET

PRO S	HERD	GRID	CED	BW	WW	YW	MILK	CEM	HP
76	29	47	8	0.8	67	116	21	6	15
73%	88%	33%	96%	91%	28%	14%	88%	64%	8%
ST	YG	CW	REA	MARB	FAT				
10	0.19	52	0.27	0.16	0.04				
93%	96%	1%	23%	97%	85%				

ACT BW	ADJ WW
84	586
CALVING EASE	
★★	



MATERNAL BROTHER OF LOTS 52-56 LEM WORLDWIDE 1001 ET

Good square calf from a great lineage.





**LOT 57**



MATERNAL BROTHER TO THE DAM OF LOT 57  
**LEM STOCKYARD 2001 ET**

*Lot 57* **LEM PRIORITY 3077 ET**

REG: RAAA 4836002 | DOB: 01-11-2023 | TAT: 3077 | 100% AR

MRLA RELOAD 56C

*Sire* **RED MRLA RESOURCE 137E**

MRLA MISS 4422B

RREDS SENECA 731C

*Dam* **LEM MS SENECS 107 ET**

LEM ONEKIND 934 ET

<b>ACT BW</b>	<b>ADJ WW</b>
86	709
<b>CALVING EASE</b>	
★★	



PRO S	HERD	GRID	CED	BW	WW	YW	MILK	CEM	HP
67	60	7	13	0.6	68	106	21	11	15
84%	32%	97%	45%	90%	25%	32%	90%	3%	6%
ST	YG	CW	REA	MARB	FAT				
13	0.29	36	-0.13	0.1	0.05				
74%	99%	11%	95%	99%	97%				

One of the top Red Angus bulls of the offering, Lot 57 is a powerful individual that stands out in the pen. His dam is a maternal sibling to 2023 high seller and ABS sire LEM Stockyard 2001 ET. Backed by a maternally superior cow family that brings extra performance and gas.

**MATERNALLY SUPERIOR**

*Powerful standout with extra performance*

## LOTS 58-59 FLUSH BROTHERS

A good pair of PIE Captain sons out of a full sister to LEM Worldwide 1001 ET. Captain has become a popular young calving ease sire out of one of the hottest Red Angus bulls in recent years, PIE Quarterback 789. The Captain's catch your eye from a young age with their dark red coat color, thickness, ideal head shape, and overall attractiveness. We believe this set of brothers will leave some really desirable females, similar to their dam and sisters.

### Lot 58 LEM CAPTAIN 3079 ET

REG: RAAA 4836000 | DOB: 01-18-2023 | TAT: 3079 | 100% AR

PIE QUARTERBACK 789

Sire PIE CAPTAIN 057

PIE BONNE BEL 852

PELTON WIDELOAD 78B

Dam LEM GINGER 118 ET

LEM MS SENECA 902 ET

ACT BW 73 | ADJ WW 690

CALVING EASE  
★★★



LOT 58

PRO S	HERD	GRID	CED	BW	WW	YW	MILK	CEM	HP
110	59	50	11	-3	74	127	32	6	11
21%	34%	26%	73%	29%	9%	5%	7%	81%	66%
ST	YG	CW	REA	MARB	FAT				
17	0.02	19	0.2	0.56	0.02				
25%	25%	69%	36%	22%	45%				

A high end performance calf from a pedigree that suggests calving ease. Great set of balanced EPDs across the board that matches his phenotype. Solid herd bull type that carries himself with ease.

### Lot 59 LEM CAPTAIN 3078 ET

REG: RAAA 4835998 | DOB: 01-21-2023 | TAT: 3078 | 100% AR

PIE QUARTERBACK 789

Sire PIE CAPTAIN 057

PIE BONNE BEL 852

PELTON WIDELOAD 78B

Dam LEM GINGER 118 ET

LEM MS SENECA 902 ET

ACT BW 74 | ADJ WW 742

CALVING EASE  
★★★



LOT 59

PRO S	HERD	GRID	CED	BW	WW	YW	MILK	CEM	HP
106	56	49	14	-2	74	129	32	7	11
26%	40%	28%	39%	48%	10%	4%	7%	51%	66%
ST	YG	CW	REA	MARB	FAT				
15	0.04	15	0.27	0.57	0.04				
41%	34%	82%	23%	21%	87%				

Heifer bull that's stout with top end numbers and performance. Very similar to his flush brother, lot 58.



## LOTS 60-61 FLUSH BROTHERS

These two Captain sons come from our foundational Red Angus donor cow, Six Mile Sierra 655A. She has made a major mark on our herd as every Red Angus bull in this year's offering leads back to her. Her progeny are consistent in their depth, fleshing ability, maternal capability, udder quality, sound feet, and fertility. Captain adds a splash of calving ease and carcass merit to a quality cow line.



DAM OF LOTS 60-61 **SIX MILE SIERA 655A**

### Lot 60 **LEM CAPTAIN 3075 ET**

REG: RAAA 4835994 | DOB: 01-18-2023 | TAT: 3075 | 100% AR

PIE QUARTERBACK 789

Sire **PIE CAPTAIN 057**

PIE BONNE BEL 852

RED BENCHMARK BETTER BEEF

Dam **SIX MILE SIERA 655A**

RED MCRAES SIERA 32X

PRO S	HERD	GRID	CED	BW	WW	YW	MILK	CEM	HP
96	62	34	13	-1	68	115	28	8	12
41%	30%	59%	50%	67%	24%	17%	29%	32%	38%
ST	YG	CW	REA	MARB	FAT				
15	0.05	14	0.24	0.44	0.04				
42%	43%	83%	29%	45%	90%				

These PIE Captain sons are born easy and grow fast. Great number set.

ACT BW	ADJ WW
72	688
CALVING EASE	
★★★	



### Lot 61 **LEM CAPTAIN 3076 ET**

REG: RAAA 4835996 | DOB: 01-15-2023 | TAT: 3076 | 100% AR

PIE QUARTERBACK 789

Sire **PIE CAPTAIN 057**

PIE BONNE BEL 852

RED BENCHMARK BETTER BEEF

Dam **SIX MILE SIERA 655A**

RED MCRAES SIERA 32X

PRO S	HERD	GRID	CED	BW	WW	YW	MILK	CEM	HP
97	68	29	13	-2.9	59	97	28	8	12
38%	19%	69%	54%	31%	58%	52%	29%	30%	38%
ST	YG	CW	REA	MARB	FAT				
17	0.05	12	0.23	0.47	0.05				
23%	43%	89%	30%	38%	93%				

Attractive and balanced calf that is backed by the foundation cow of our program.

ACT BW	ADJ WW
70	623
CALVING EASE	
★★★	





## LOTS 62-65 FLUSH BROTHERS

The long anticipated first set of calves from our purchase on the 2022 Pieper Red Angus Spring Sale, PIE Long Haul 1344. Long Haul has caught the attention of cattlemen and breeders across the continent for his outlier length of body, added performance, hip expression, carcass merit, dark red coat, and extra libido and fertility. He is backed by a rare and highly sought after pedigree, combining the valuable Bieber Hard Drive with the prominent Pieper donor dam PIE Ruby 520, also the dam of PIE Quarterback. We have been very pleased with the quality of his progeny and have reason to believe he will be a female maker deluxe with an extra shot of growth.



**LOT 62**

### Lot 62 LEM LONG HAUL 3070 ET



REG: RAAA 4835984 | DOB: 01-25-2023 | TAT: 3070 | 100% AR

BIEBER HARD DRIVE Y120

Sire **PIE LONG HAUL 1344**

PIE RUBY 520

PELTON WIDELOAD 78B

Dam **LEM GINGER 116 ET**

LEM MS SENECA 902 ET

ACT BW	ADJ WW
84	711
CALVING EASE	
★★	



PRO S	HERD	GRID	CED	BW	WW	YW	MILK	CEM	HP
108	50	58	12	-3	70	110	27	5	13
23%	53%	15%	67%	29%	17%	24%	43%	88%	22%
ST	YG	CW	REA	MARB	FAT				
16	-0.1	36	0.62	0.55	-0.01				
30%	3%	11%	2%	24%	8%				



REFERENCE SIRE **PIE LONG HAUL 1344**

First PIE Long Haul son to sell and he is a good one. All the Long Haul's exhibit their sire's tremendous length and growth with great feet and legs. We think Long Haul's best contribution will be the outstanding females he is already producing. Our breeding season was nearly over when we purchased Long Haul in 2022, so look for many more sons in the coming years.



### Lot 63 LEM LONG HAUL 3072 ET

REG: RAAA 4835988 | DOB: 01-24-2023 | TAT: 3072 | 100% AR

BIEBER HARD DRIVE Y120

*Sire* PIE LONG HAUL 1344

PIE RUBY 520

PELTON WIDELOAD 78B

*Dam* LEM GINGER 116 ET

LEM MS SENECA 902 ET

ACT BW	ADJ WW
82	648
CALVING EASE	
★★	



PRO S	HERD	GRID	CED	BW	WW	YW	MILK	CEM	HP
103	42	61	10	-1.4	79	130	27	4	13
30%	69%	12%	83%	60%	4%	4%	43%	93%	22%
ST	YG	CW	REA	MARB	FAT				
15	-0.09	35	0.59	0.51	0				
51%	4%	13%	2%	30%	14%				

Wide based and big middled with a great EPD set.

### Lot 64 LEM LONG HAUL 3071 ET

REG: RAAA 4835986 | DOB: 01-16-2023 | TAT: 3071 | 100% AR

BIEBER HARD DRIVE Y120

*Sire* PIE LONG HAUL 1344

PIE RUBY 520

PELTON WIDELOAD 78B

*Dam* LEM GINGER 116 ET

LEM MS SENECA 902 ET

ACT BW	ADJ WW
87	631
CALVING EASE	
★★	



PRO S	HERD	GRID	CED	BW	WW	YW	MILK	CEM	HP
122	53	69	10	-0.6	82	137	27	4	13
9%	47%	6%	81%	74%	2%	2%	43%	93%	22%
ST	YG	CW	REA	MARB	FAT				
16	0.02	44	0.42	0.54	0				
27%	26%	3%	7%	25%	23%				

Long Haul son that will put the performance back in your calf crop.

### Lot 65 LEM LONG HAUL 3073 ET

REG: RAAA 4835990 | DOB: 01-23-2023 | TAT: 3073 | 100% AR

BIEBER HARD DRIVE Y120

*Sire* PIE LONG HAUL 1344

PIE RUBY 520

PELTON WIDELOAD 78B

*Dam* LEM GINGER 116 ET

LEM MS SENECA 902 ET

ACT BW	ADJ WW
80	586
CALVING EASE	
★★	



PRO S	HERD	GRID	CED	BW	WW	YW	MILK	CEM	HP
115	65	50	12	-3	72	115	27	5	13
15%	24%	27%	56%	29%	15%	16%	43%	83%	22%
ST	YG	CW	REA	MARB	FAT				
19	0.01	28	0.34	0.55	0.01				
9%	20%	32%	14%	24%	39%				

### Lot 67 LEM JUST RIGHT 3081

REG: RAAA 4837588 | DOB: 01-15-2023 | TAT: 3081 | 100% AR

PIE THE COWBOY KIND 343

*Sire* PIE JUST RIGHT 540

RAISLAND LAKOTA 311-158

BROWN JYJ REDEMPTION Y1334

*Dam* LEM REDEMPTION 615 ET

SIX MILE SIERA 655A

ACT BW	ADJ WW
88	762
CALVING EASE	
★★	



PRO S	HERD	GRID	CED	BW	WW	YW	MILK	CEM	HP
97	58	38	11	-1.6	61	98	22	6	7
39%	36%	51%	75%	56%	52%	50%	84%	76%	97%
ST	YG	CW	REA	MARB	FAT				
18	-0.01	20	0.23	0.48	0.01				
12%	15%	66%	30%	36%	25%				

PIE Just Right son that's been a standout since birth. His redemption dam is a deep bodied, perfect uddered model of a Red Angus cow. He'll sire heavy feeder steers and great replacement females.

### Lot 68 LEM TOWNSHIP 3082

REG: RAAA 4837608 | DOB: 02-03-2023 | TAT: 3082 | 100% AR

RED MRLA RESOURCE 137E

*Sire* RED U2 TOWNSHIP 17G

U2 BEAUTY 113Z

PIE ONE OF A KIND 352

*Dam* LEM ONEKIND 929 ET

LEM MS DIRECTION 712 ET

ACT BW	ADJ WW
91	792
CALVING EASE	
★★	



PRO S	HERD	GRID	CED	BW	WW	YW	MILK	CEM	HP
105	60	45	9	3.2	82	141	21	6	16
26%	32%	35%	94%	99%	2%	1%	90%	66%	4%
ST	YG	CW	REA	MARB	FAT				
14	0.1	35	0.14	0.32	0.01				
62%	67%	12%	49%	74%	37%				

Stout made with style. U2 Township son from a high performing One of a Kind daughter. Expect him to sire top performing steers and impressive daughters.

### Lot 69 LEM CAPTAIN 3084

REG: RAAA 4837620 | DOB: 01-18-2023 | TAT: 3084 | 100% AR

PIE QUARTERBACK 789

Sire PIE CAPTAIN 057

PIE BONNE BEL 852

HXC ALLEGIANCE 5502C

Dam LEM ALLEGIANCE 014 ET

LEM MS DIRECT 840 ET

ACT BW	ADJ WW
71	745
CALVING EASE	
★★★	



REFERENCE SIRE PIE CAPTAIN 057

PRO S	HERD	GRID	CED	BW	WW	YW	MILK	CEM	HP
85	40	44	13	-3.2	68	115	31	7	13
59%	72%	37%	45%	26%	23%	16%	10%	57%	18%
ST	YG	CW	REA	MARB	FAT				
12	0.12	19	0.13	0.59	0.05				
80%	76%	70%	51%	19%	93%				

Great balance and numbers on this Captain son. From a good footed Allegiance daughter that's easy fleshing and deep. Should sire moderate birth weights.

### Lot 70 LEM CINCH 3085

REG: RAAA 4837606 | DOB: 01-12-2023 | TAT: 3085 | 100% AR

LSF SAGA 1040Y

Sire PIE CINCH 4126

TKP BONNE BEL 110

RREDS SENECA 731C

Dam LEM MS SENECA 904 ET

LEM REDEMPTION 616 ET

ACT BW	ADJ WW
79	671
CALVING EASE	
★★★	



LOT 70

PRO S	HERD	GRID	CED	BW	WW	YW	MILK	CEM	HP
77	71	6	13	-4.5	52	80	22	7	11
71%	16%	97%	50%	10%	80%	82%	84%	45%	48%
ST	YG	CW	REA	MARB	FAT				
19	0.15	20	0	0.21	0.04				
9%	89%	65%	79%	93%	89%				

Thick made, dark coated Cinch son. From a full sister to the 902 donor cow (dam of Lot 52-56 & LEM Worldwide). Use on heifers or cows.

### Lot 71 LEM CAPTAIN 3083

REG: RAAA 4837616 | DOB: 01-18-2023 | TAT: 3083 | 100% AR

PIE QUARTERBACK 789

Sire PIE CAPTAIN 057

PIE BONNE BEL 852

HXC ALLEGIANCE 5502C

Dam LEM ALLEGIANCE 938 ET

SIX MILE SIERA 655A

ACT BW	ADJ WW
77	682
CALVING EASE	
★★★	



SIRE OF LOT 70 PIE CINCH 4126

PRO S	HERD	GRID	CED	BW	WW	YW	MILK	CEM	HP
78	41	37	11	-3.3	61	101	29	6	13
69%	70%	53%	75%	24%	50%	43%	20%	74%	25%
ST	YG	CW	REA	MARB	FAT				
13	0.09	16	0.23	0.54	0.05				
71%	64%	80%	30%	25%	97%				

Heifer bull with balanced numbers and phenotype to match.



DAM OF LOT 72 LEM ONEKIND 934 ET

### Lot 72 LEM COMPLETE 3087



REG: RAAA 4837614 | DOB: 02-26-2023 | TAT: 3087 | 100% AR

KJL/CLZB COMPLETE 7000E

*Sire* PIE COMPLETE 1167

PIE POLLY 8254

PIE ONE OF A KIND 352

*Dam* LEM ONEKIND 934 ET

LEM MS DIRECTION 712 ET

ACT BW	ADJ WW
81	799
CALVING EASE	
★★	



PRO S	HERD	GRID	CED	BW	WW	YW	MILK	CEM	HP
87	25	62	13	-2	78	124	22	7	13
56%	92%	11%	53%	48%	5%	7%	81%	53%	22%
ST	YG	CW	REA	MARB	FAT				
10	0.24	47	-0.11	0.64	0.02				
92%	99%	2%	94%	13%	51%				

Performance and carcass standout with top maternal traits. A maternal sibling to ABS Sire, LEM Stockyard 2001 ET. Dark red calf that performed right with the rest of the herd despite being the youngest of the Reds.

### Lot 73 LEM TOWNSHIP 3086

REG: RAAA 4837604 | DOB: 02-08-2023 | TAT: 3086 | 100% AR

RED MRLA RESOURCE 137E

*Sire* RED U2 TOWNSHIP 17G

U2 BEAUTY 113Z

RREDS SENECA 731C

*Dam* LEM MS SENECA 902 ET

LEM REDEMPTION 616 ET

ACT BW	ADJ WW
88	711
CALVING EASE	
★★	



PRO S	HERD	GRID	CED	BW	WW	YW	MILK	CEM	HP
96	57	39	9	0.8	68	108	21	6	14
41%	39%	49%	90%	91%	26%	29%	88%	70%	10%
ST	YG	CW	REA	MARB	FAT				
14	0.12	27	0.11	0.48	0.03				
56%	77%	37%	56%	36%	73%				

Heavy made U2 Township son with Worldwide's dam. Expect him to sire thick performance oriented sons and outstanding daughters.



LOT 73



PATERNAL GRANDSIRE OF LOT 72 KJL/CLZB COMPLETE 7000E



SIRE OF LOT 73 RED U2 TOWNSHIP 17G



# AGE ADVANTAGED BULLS



**LOT 74**

## Lot 74 LEM STELLAR 2108

REG: AMGV1584707 | DOB: 9/16/22 | TAT: 2108K | 6.3GV, 93.8AN

MOHNEN SUBSTANTIAL 272

*Sire* SITZ STELLAR 726D

SITZ PRIDE 200B

S A V RESOURCE 1441

*Dam* MS RESOURCE 038 ET

MS CHARLO 503C ET

Black Polled
<b>ACT BW</b> <b>ADJ WW</b>
74                      730
<b>CALVING EASE</b>
★★



CED	BW	WW	YW	MILK	CEM	HP	ST	YG	CW	REA	MARB	FPI
10	-0.4	87	149	21	4	5	13	0.20	59	0.44	0.45	91.70
85%	45%	4%	1%	70%	90%	60%	75%	>95%	3%	75%	20%	10%

Herd Bull! Long, deep, thick, and performance. Moderate birth with top performance traits and a good maternal pedigree.



REFERENCE SIRE SITZ STELLAR 726D

**Lot 75 LEM INFINITY 2109**

REG: AMGV1584708 | DOB: 9/16/22 | TAT: 2109K | 30.5GV, 68.6AN, 0.9AR

TAU MR IN FOCUS 22Z

*Sire* INFINITY 47C

TAU MIA 363A

BALDRIDGE BRONC

*Dam* MS BRONC 858 ET

RIGHT KIND SISTER 6204D

Black	
Polled	
<b>ACT BW</b>	<b>ADJ WW</b>
<b>80</b>	<b>704</b>
<b>CALVING EASE</b>	
★★★	



CED	BW	WW	YW	MILK	CEM	HP	ST	YG	CW	REA	MARB	FPI
13	-1.3	74	118	27	6	8	18	-0.02	35	0.54	0.61	90.59
50%	30%	40%	35%	15%	65%	25%	10%	70%	55%	45%	10%	15%

Thick and easy fleshing just like his dam. Nicely balanced, heavy muscled Balancer. Dam has a great udder.



**LOT 75**

**Lot 76 LEM EXPIDITION 2115**

REG: AMGV1585669 | DOB: 10/10/22 | TAT: 2115K | 4.7GV, 87.4AN, 1.65AR

T K EXPEDITION F729

*Sire* T K EXPEDITION H282

T K MADGE F651

S A V RESOURCE 1441

*Dam* MS RESOURCE 820 ET

MS BLUESTEM 300 A ET

Black	
Polled	
<b>ACT BW</b>	<b>ADJ WW</b>
<b>84</b>	<b>750</b>
<b>CALVING EASE</b>	
★★	



CED	BW	WW	YW	MILK	CEM	HP	ST	YG	CW	REA	MARB	FPI
12	0.7	88	147	26	3	5	11	0.09	57	0.51	0.47	92.36
60%	75%	4%	2%	25%	95%	60%	90%	>95%	3%	60%	20%	10%

One of our favorites. Heavy made with extra muscle, depth, and length. Great phenotype and from one of our top cow families. Easy fleshing dam has an ideal udder.



**LOT 76**

**Lot 77 LEM STELLAR 2110**

REG: AMGV1585005 | DOB: 8/15/22 | TAT: 2110K | 6.3GV, 93.8AN

MOHNEN SUBSTANTIAL 27Z

*Sire* SITZ STELLAR 726D

SITZ PRIDE 200B

LD CAPITALIST 316

*Dam* MS 316 127 ET

MS CHARLO 505C ET

Black	
Polled	
<b>ACT BW</b>	<b>ADJ WW</b>
<b>75</b>	<b>717</b>
<b>CALVING EASE</b>	
★★	



CED	BW	WW	YW	MILK	CEM	HP	ST	YG	CW	REA	MARB	FPI
13	-1.6	86	143	22	7	5	14	0.25	59	0.38	0.53	94.68
45%	25%	5%	3%	60%	40%	60%	60%	>95%	3%	85%	15%	4%

Stellar son with calving ease, performance, and style. Clean made and walks like a cat.



SIRE OF LOT 75 TAU Infinity 47C

### Lof 78 ELEM XPIDITION 2111

REG: AMGV1585883 | DOB: 10/3/22 | TAT: 2111K | 93.75AN, 6.25GV

T K EXPEDITION F729

Sire T K EXPEDITION H282

T K MADGE F651

LD CAPITALIST 316

Dam MISS 316 029 ET

MS NET WORTH 341 A

Black Polled

ACT BW	ADJ WW
86	
CALVING EASE	
★★	



CED	BW	WW	YW	MILK	CEM	HP	ST	YG	CW	REA	MARB	FPI
11	1.3	91	149	29	4	4	12	0.14	66	0.52	0.60	96.66
75%	85%	2%	1%	10%	90%	75%	85%	>95%	1%	60%	10%	2%

Sharp profiling, thick made bull with loads of width.

### Lof 79 LEM EXPIDITION 2112

REG: AMGV1585884 | DOB: 10/3/22 | TAT: 2112K | 98.4AN, 1.6GV

T K EXPEDITION F729

Sire T K EXPEDITION H282

T K MADGE F651

S A V RENOWN 3439

Dam MS RENOWN 135 ET

LEM MISS BRONC 923

Black Polled

ACT BW	ADJ WW
85	
CALVING EASE	
★★	



CED	BW	WW	YW	MILK	CEM	HP	ST	YG	CW	REA	MARB	FPI
12	-0.7	88	146	27	3	9	10	0.16	58	0.38	0.47	93.83
60%	40%	4%	2%	15%	95%	20%	95%	>95%	3%	85%	20%	5%

Stout, thick, and long. Outstanding Renown dam that's a full sister to the dam of lots 1-4.

### Lof 80 LEM DENVER 2113

REG: AMGV1584709 | DOB: 9/16/22 | TAT: 2113K | 35.9GV, 64.1AN

EXAR DENVER 2002B

Sire TWIN OAK DENVER 823F ET

MS C-CROSS EC / 7309T

TOP CHOICE 474 B ET

Dam MS TOP CHOICE 636D ET

BRILLIANCE 140Y

Black Polled

ACT BW	ADJ WW
84	705
CALVING EASE	
★★	



CED	BW	WW	YW	MILK	CEM	HP	ST	YG	CW	REA	MARB	FPI
13	0.9	66	98	26	7	6	14	-0.02	34	0.40	0.50	79.35
50%	80%	75%	80%	25%	45%	45%	55%	70%	60%	75%	20%	65%

Rugged made, age advantaged Balancer. Able to stand heavy use and sire top feeders.

### Lof 81 LEM STELLAR 2114

REG: Pending | DOB: | TAT: 2114 | 100% AN

MOHNEN SUBSTANTIAL272

Sire SITZ STELLAR 726D

MOHNEN GLYN MAWR ELBA 1758

ELLINGSON BOARDWALK 7914

Dam LEM MS BOARDWALK 155

LEM MS CAPITALIST 640 ET

ACT BW	ADJ WW
80	734
CALVING EASE	
★★★	

CED	BW	WW	YW	MILK	CEM	\$EN	CW	MARB	RE	FAT
4	1.8	62	109	21	9	-14	38	0.62	0.50	0.040
70%	65%	55%	55%	85%	45%	50%	80%	60%	70%	85%
SM	SW	SF	SG	SB	SC					
60	59	88	46	133	233					
65%	55%	50%	60%	65%	70%					

Purebred Angus heifer bull. Nicely balanced and free striding.

## AGE ADVANTAGED RED BULLS

### Lof 82 LEM CAPTAIN 2105

REG: RAAA 4811713 | DOB: 09-16-2022 | TAT: 2105 | 100% AR

PIE QUARTERBACK 789

Sire PIE CAPTAIN 057

PIE BONNE BEL 852

HXC ALLEGIANCE 5502C

Dam LEM ALLEGIANCE 936 ET

SIX MILE SIERA 655A

ACT BW	ADJ WW
80	NA
CALVING EASE	
★★	



PRO S	HERD	GRID	CED	BW	WW	YW	MILK	CEM	HP
104	65	38	11	-3.2	67	104	31	6	13
28%	23%	50%	71%	26%	29%	37%	13%	74%	25%
ST	YG	CW	REA	MARB	FAT				
17	0.02	16	0.46	0.62	0.05				
20%	25%	80%	5%	15%	97%				

Well balanced PIE Captain son with moderate birth and from a neat uddered dam.

### Lof 83 LEM SENECA 2101

REG: RAAA 4811691 | DOB: 08-09-2022 | TAT: 2101 | 100% AR

BIEBER ROLLIN DEEP Y118

Sire RREDS SENECA 731C

RREDS ASTER 309A

PARINGA IRON ORE E27

Dam HXC 372A

HXC 832U

ACT BW	ADJ WW
72	NA
CALVING EASE	
★★★★	



PRO S	HERD	GRID	CED	BW	WW	YW	MILK	CEM	HP
77	53	24	16	-4.4	61	95	19	9	10
71%	47%	78%	16%	11%	49%	56%	96%	19%	72%
ST	YG	CW	REA	MARB	FAT				
16	0.1	44	0.48	0.15	0.05				
34%	70%	3%	5%	97%	92%				

The first ever Fall calf born on our place. Heifer calving Seneca son out of an 11 year donor cow with a great udder. Thick made and stylish with muscle.



**LOT 84**



REFERENCE SIRE **BIEBER CL STOCK MARKET E119**

*Lot 84* **LEM STOCKMARKET 2103**



REG: RAAA 4811717 | DOB: 08-25-2022 | TAT: 2103 | 100% AR

PIE STOCKMAN 4051

*Sire* **BIEBER CL STOCKMARKET E119**

BIEBER CL ADELLE 475C

HXC ALLEGIANCE 5502C

*Dam* **LEM ALLEGIANCE 017 ET**

LEM MS DIRECT 840 ET

ACT BW	ADJ WW
75	NA
<b>CALVING EASE</b>	
★★★★	



PRO S	HERD	GRID	CED	BW	WW	YW	MILK	CEM	HP
128	44	84	14	-2.8	73	127	23	9	15
6%	66%	1%	27%	32%	11%	5%	76%	19%	5%
ST	YG	CW	REA	MARB	FAT				
12	0.16	27	0.08	1.25	0.04				
83%	90%	39%	63%	1%	91%				

Herd Bull! Tremendous Stockmarket son with outstanding thickness and phenotype. Great EPD profile.

**HERD BULL!**

*Great data profile with phenotype*



### Lot 85 LEM WIDELOAD 2107

REG: RAAA 4749385 | DOB: 09-16-2022 | TAT: 2107 | 100% AR

SLGN WIDELOAD 920W

Sire PELTON WIDELOAD 78B

PELTON MISS JAYLA 0508S

ANDRAS NEW DIRECTION R240

Dam LEM MS DIRECT 839 ET

SIX MILE SIERA 655A

PRO S	HERD	GRID	CED	BW	WW	YW	MILK	CEM	HP
101	37	64	11	-0.8	68	120	23	3	11
32%	77%	9%	80%	71%	24%	10%	78%	97%	58%
ST	YG	CW	REA	MARB	FAT				
14	0.16	47	0.22	0.42	0.03				
56%	90%	2%	32%	49%	68%				

ACT BW	ADJ WW
79	NA
CALVING EASE	
★★	



LOT 85

Standout Wideload son. Attractive phenotype and balanced numbers. Beautiful, heavy producing dam with a great udder.

### Lot 86 LEM SENECA 2106

REG: RAAA 4811707 | DOB: 08-11-2022 | TAT: 2106 | 100% AR

BIEBER ROLLIN DEEP Y118

Sire RREDS SENECA 731C

RREDS ASTER 309A

ANDRAS NEW DIRECTION R240

Dam LEM MS DIRECT 840 ET

SIX MILE SIERA 655A

PRO S	HERD	GRID	CED	BW	WW	YW	MILK	CEM	HP
91	61	30	15	-4.5	56	96	19	9	12
49%	31%	69%	17%	10%	68%	55%	96%	15%	32%
ST	YG	CW	REA	MARB	FAT				
16	0.18	30	0.18	0.3	0.06				
31%	95%	25%	41%	79%	99%				

ACT BW	ADJ WW
72	NA
CALVING EASE	
★★★	



### Lot 87 LEM LEGEND 2102

REG: RAAA 4811697 | DOB: 10-01-2022 | TAT: 2102 | 100% AR

BROWN BLW LEGEND A1965

Sire ALC MR LEGEND F49

ALC MISS KING B417

PIE THE COWBOY KIND 343

Dam LEM MS COWKIND 863 ET

HXC 372A

PRO S	HERD	GRID	CED	BW	WW	YW	MILK	CEM	HP
64	18	46	13	-2.9	55	89	24	6	10
87%	96%	34%	53%	31%	73%	69%	66%	70%	69%
ST	YG	CW	REA	MARB	FAT				
11	0.09	15	-0.04	0.69	0.02				
88%	62%	83%	86%	9%	53%				

ACT BW	ADJ WW
84	NA
CALVING EASE	
★★	



Well balanced and growthy from a great uddered Cowboy Kind dam.

### Lot 88 LEM SENECA 2104

REG: RAAA 4811715 | DOB: 09-16-2022 | TAT: 2104 | 100% AR

BIEBER ROLLIN DEEP Y118

Sire RREDS SENECA 731C

RREDS ASTER 309A

HXC ALLEGIANCE 5502C

Dam LEM ALLEGIANCE 937 ET

SIX MILE SIERA 655A

PRO S	HERD	GRID	CED	BW	WW	YW	MILK	CEM	HP
105	60	45	11	-1.3	66	107	20	6	12
27%	32%	37%	75%	61%	31%	32%	92%	66%	40%
ST	YG	CW	REA	MARB	FAT				
17	0.15	40	0.33	0.43	0.05				
25%	87%	6%	15%	47%	95%				

ACT BW	ADJ WW
82	NA
CALVING EASE	
★★	



### Lot 89 LEM FUSION 2116

REG: AMGV1586869 | DOB: 8/11/22 | TAT: 2116K | 50GV, 50AR

ANDRAS IN FOCUS B175

Sire ANDRAS FUSION R236

ANDRAS BELLE B167

POST ROCK STAR 274U2

Dam MS STAR 317 A

635

RED	POLLED	ACT BW	ADJ WW
		70	714
CALVING EASE		★★★★	

RED	POLLED



Outstanding half blood Balancer calving ease bull. Exhibits tremendous growth, structure, and balance. His 11 year old dam has a great udder and has raised several herd bulls.

Balanced numbers. 18 month old bulls can handle lots of cows and don't require special care.

*Selling two flush sisters from*  
**LEM MS FUSION 879**  
*cow family*



**LOTS 90-91 FLUSH SISTERS**

RUSL LADY PARADOX 324 AND 3034 are maternal granddaughters of our lead donor, LEM MS FUSION 879, that was purchased from Lemke Cattle in 2019. She went on to be the 2019 Champion Red Angus heifer at the Kansas State Fair. Her first calf, RUSL Ladybelle 079, sired by Cinch, was the Reserve Red Angus Heifer at the 2021 Kansas State Fair, and is the donor dam to these two heifers.

Ladybelle has winning phenotype, but also has nine EPDs in the top 25% of the breed, has always bred first cycle, and flushed 8 embryos while nursing her first calf. We got seven calves from those eight embryos, which is the only reason these two heifers are for sale.

We decided to use the black/red carrier Plum Creek Paradox to boost growth and power with this flush. That cross resulted in top 15% WW, 10% YW, and 7% average daily gain. You'll be able to pair these heifers with a calving ease bull and produce big stout calves at weaning. Not only do they have performance, but an outstanding phenotype, going back to both a Kansas State Fair Champion and Reserve Champion on the dam's side. These heifers are prime candidates for range or ring. While both heifers are high performing, the black heifer has a shot more power and plenty of bloom in her center carriage, and the red heifer boasts a cleaner, sharper front one-third, and a deep broody flank.

Take your pick- we like them both!

*Lot 90* **RUSL LADY PARADOX 3034**

REG: RAAA 4823905 | DOB: 02-01-2023 | TAT: 3034 | 100% AR

GAMBLES HOT ROD

*Sire* **PLUM CREEK PARADOX 161B**

S H MISS ANNIE LU 6087

PIE CINCH 4126

*Dam* **RUSL LADYBELLE**

LEM MS FUSION 879

PRO S	HERD	GRID	CED	BW	WW	YW	MILK	CEM	HP
84	42	42	11	-0.5	71	120	23	6	12
61%	69%	42%	77%	76%	15%	10%	76%	69%	37%
ST	YG	CW	REA	MARB	FAT				
11	0.14	41	0.09	0.18	0.01				
85%	84%	5%	62%	96%	39%				

*Lot 91* **RUSL LADY PARADOX 324**

REG: RAAA 4823899 | DOB: 01-27-2023 | TAT: 324 | 100% AR

GAMBLES HOT ROD

*Sire* **PLUM CREEK PARADOX 161B**

S H MISS ANNIE LU 6087

PIE CINCH 4126

*Dam* **RUSL LADYBELLE**

LEM MS FUSION 879

PRO S	HERD	GRID	CED	BW	WW	YW	MILK	CEM	HP
84	42	42	11	-0.5	71	120	23	6	12
61%	69%	42%	77%	76%	15%	10%	76%	69%	37%
ST	YG	CW	REA	MARB	FAT				
11	0.14	41	0.09	0.18	0.01				
85%	84%	5%	62%	96%	39%				



## COMMERCIAL HEIFERS

We are again offering Red Angus commercial open yearling heifers. All home raised and from the heart of our commercial herd. All heifers have been on a complete vaccination program, including bangs, poured, and pelvic examined. selling in groups of 4 with the winning bidder having the option to roll the next 4.

**LOTS 92, 93, 94, 95**

**LOTS 96, 97, 98, 99**

*New this Year!*

## YOUTH HEIFER GIVEAWAY

***That's right! Lemke Cattle will be giving a commercial Red Angus open yearling heifer to a lucky young person!***

We've been blessed to have built this program & continue it's growth & progress. We've also been blessed with our great customers & their trust in our program. We at LEMKE CATTLE feel strongly about the future of the cattle business & our youth, so we'd like to pay forward and give a youngster a boost in the cattle business!

To enter and win, you must be between 5 and 18 years old, present at the sale, and able to provide a great new home for this nice Pie Captain 057 daughter.

Registration for this nice heifer will be in the Sale Barn Office. We will draw for the heifer after completion of the sale!

Lemke Cattle  
1757 Road 2500  
Lawrence, NE 68957



*Friday* ANNUAL BULL & FEMALE SALE  
**FEBRUARY 9, 2024**  
AT THE RANCH NEAR LAWRENCE, NE *1:00 pm*

LEM *Entice* 3015 ET



LEM *Resilient* 3047



LEM *Stellar* 2108



LEM *Resource* 3065 ET



LEM *Resource* 3066 ET



LEM *Stockmarket* 2103



*Reliable Leading Genetics*

A foundation built upon **MATERNAL STRENGTH** and **EASY KEEPING FEMALES**  
with true **POWER** and **PERFORMANCE!**